

Surface Mount

FLOOR DOOR, 150PSF

The Surface Mount Floor Door is designed for retrofit applications with internal flanges for easy mounting. This door is an economical option for areas where water or moisture intrusion is not a concern.

DETAILS

LOAD 150psf live load

MATERIAL Aluminum: 3/16 inch, mill finish

COVER Diamond tread plate

FRAME Interior angle (flange)

INSTALLATION Surface mount, mechanically fastened

SPRING Coil Type 17-7 Stainless Steel, enclosed in Type 316 Stainless Steel telescopic tubes

HINGES Heavy duty Type 316 Stainless Steel

HOLD OPEN ARM Type 316 Stainless Steel automatic hold open arm with red vinyl grip handle, locks cover in open position

LATCH Slam latch Type 316 Stainless Steel with inside lever handle, includes removable 5/16 inch steel square "L" handle and threaded plug

GASKET EPDM, around door perimeter

OPTIONS Padlock Hasps, Locks, Finishes, Gasket, Safety Grates, Safety Nets, Safety Rails, Skirting



ORDER GUIDE

MODEL	WIDTH	X	LENGTH
BFDNLA		X	SELN
	Standard Sizes (W x L)		
	24" x 24"		
	30" x 30"		
	30" x 36"		
	36" x 36"		
	42" x 42"		

FRAME

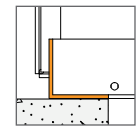

Interior Angle Mech. Fastened

Additional sizes available, call for more information.

Water Tight

WELL HATCH, 625PSF

Babcock-Davis' Water Tight Well Hatch is designed for water-tightness up to 10 foot water column and 625psf load capacity. With waterproof gaskets and pressure locks, this hatch design is ideal for wells and areas prone to flooding.

DETAILS

LOAD 625psf live load

MATERIAL Aluminum: 1/4 inch, mill finish

COVER Diamond tread plate

FRAME Angle

INSTALLATION Surface mount, mechanically fastened

SPRING Coil Type 17-7 Stainless Steel enclosed in Type 316 Stainless Steel telescopic tubes

HINGES Heavy duty Type 316 Stainless Steel butt hinges

HOLD OPEN ARM Type 316 Stainless Steel automatic hold open arm locks cover in open position

LATCH Type 316 Stainless Steel pressure locks

CERTIFICATION Tested to 10 foot hydrostatic pressure

OPTIONS Padlock Hasps, Locks, Finishes, Gasket, Safety Grates, Safety Nets, Safety Rails, Skirting

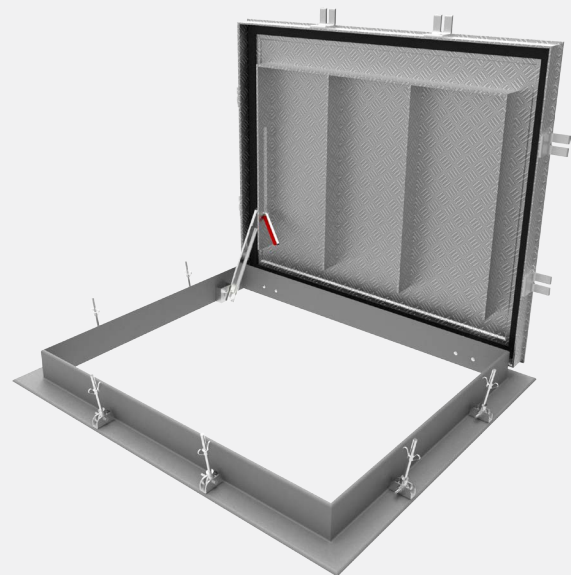

ORDER GUIDE

MODEL	WIDTH	X	LENGTH
BFDWTA		X	SSW
	Standard Sizes (W x L)		
	24" x 24"		
	30" x 30"		
	30" x 36"		
	36" x 36"		
	42" x 42"		

FRAME

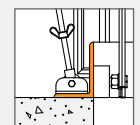

Angle Frame Mech. Fastened

Additional sizes available, call for more information.