

IU SERIES

INSTALLATION INSTRUCTIONS FOR IU; INSULATED FIRE RATED ACCESS PANELS FOR CEILING ONLY; ALL SURFACES

Failure to follow the instructions listed below may void the fire rating of this unit.

1. For vertical or horizontal installation (see attached listed label on door) in wood or steel stud drywall and/or masonry construction, door framing will be prepared in accordance with specification for the required fire rating.
2. Finished door frame opening is to be 1/4" (6mm) larger than the door frame for each dimension of the door (Width + 1/4"(6mm), Height + 1/4"(6mm)).
3. The door panel must be installed square with the door frame.
4. Do not twist or distort the door frame in any direction.
5. The door frame is to be fastened directly and securely to the wall or ceiling framing through all the holes provided in the frame. Screws shall penetrate 1/2"(13mm) into steel studs and 1"(25mm) into wood.
6. Cement block construction must have all inner holes capped or filled.
7. For masonry block or cast concrete construction, #10 concrete or masonry anchors that penetrate 1-1/2"(38mm) must be used for all holes provided in the door frame.
8. Install interior release handle as shown. Failure to install interior release handle will negate fire-rating.
9. When correctly installed, the door will close and latch when released from the open position, which is in the range of 80°-86°.

Following these instructions will maintain the fire rating of the assembly as listed (see attached listed label). The installer should check with the local jurisdiction authority before installation to determine any additional requirements.

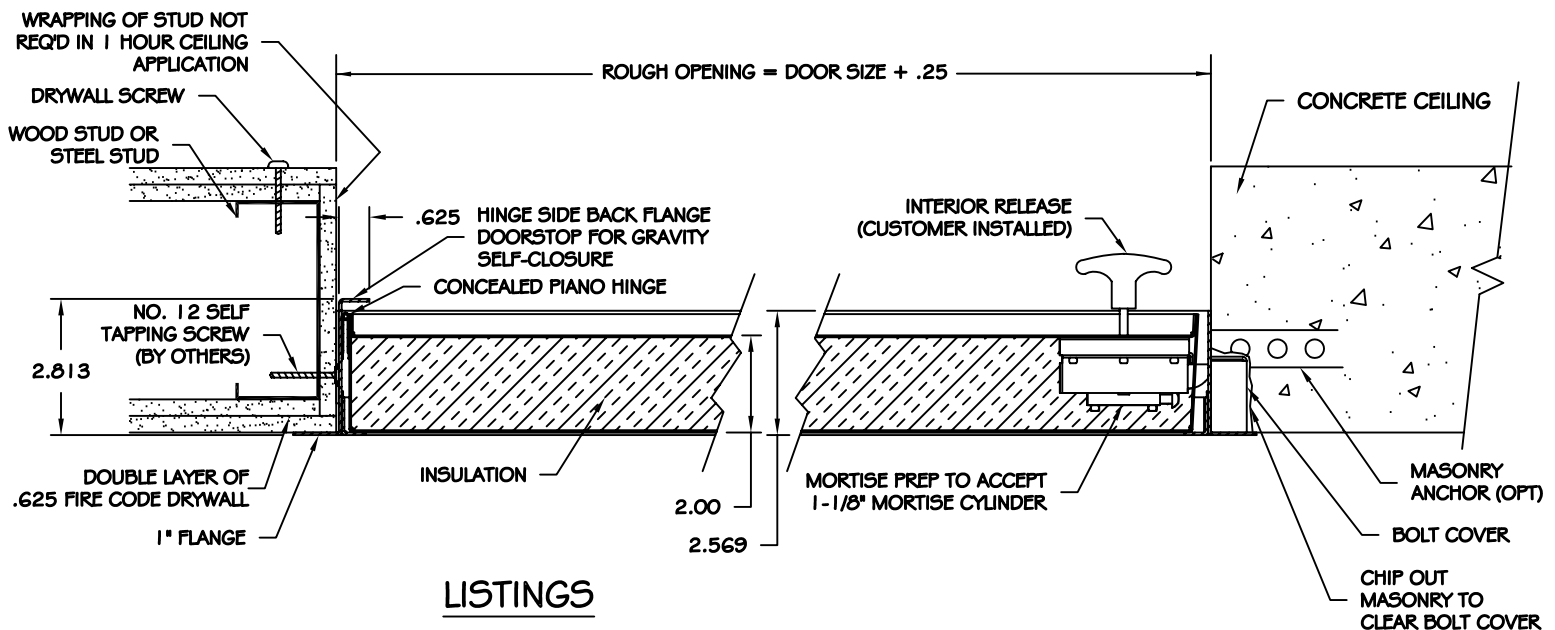

LISTINGS

Warnock Hersey

