



# Entrance Mats + Grilles

12 4813 + 12 4816 | PRODUCT CATALOG



Great Products. Better Partners.



Great Products. Better Partners.



## FIRE PROTECTION SPECIALTIES

05 5000



## FALL PROTECTION

05 5213 / 07 7200



## ACCESS DOORS

08 3100



## ROOF HATCHES + SMOKE VENTS

07 7200



## STAIR TREADS + NOSINGS

05 5000



## LUMINOUS EGRESS

10 1443



## FLOOR DOORS

08 3483

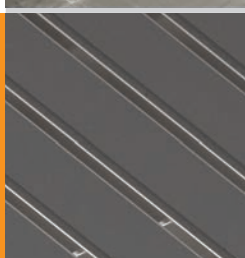

## ENTRANCE MATS + GRILLES

12 4813/12 4816







First  
appearances  
matter.

## Entrance Mats + Grilles

Specification Support	5
System Selection Guide	6
LEED	7

## Grilles

<b>ARCHITECTURAL</b>	<b>8-11</b>
proGRIL™	8
eleGRIL™	9
alumaGRIL™	10
GRATEdesign	11

<b>RIGID</b>	<b>12-13</b>
GRATEdesign®	12
EnvIRONtread® II	13

<b>ROLL-UP</b>	<b>14</b>
GRATEdesign®	14

## Mats

<b>ROLL-UP</b>	<b>15-17</b>
QuietFLEX®	15
MATdesign®	16
MATrac™	17

<b>VINYL</b>	<b>18-19</b>
MAXtread™	18
MAXgrid™	19

## Options

Color Anodizing	20
Dual Treads	20
Treads	21-23

More than a source for your  
commercial building products...

# A Partnership

Dear Partner,

Thank you for your continued confidence in Babcock-Davis. On behalf of the entire company, I can tell you that we are motivated and inspired from our partnership. Working with you to deliver commercial building products and services that exceed your expectations is our top priority.

For over 100 years, we have remained dedicated to building and designing the highest quality commercial building products. Our product offering and manufacturing capabilities have grown significantly over the years thanks to the quality commitment of our many hard working employees in Minnesota. We proudly stand behind every product that we ship out every day around the world.

Sourcing commercial building products is never as simple as it seems. This is particularly true when it comes to the type of specialty and architectural building products that we supply. It takes a collaborative effort of resources and information to get the job done right. We understand all the complexities and time sensitivities involved. This is why we have built such a strong network of people and processes to better serve all of you, our partners. We do so with flexibility that meets your needs - not ours.

We are excited for the future and the opportunity to work with you and to continue to exceed your expectations. You have our commitment that we will work hard every day to help you succeed.

If there is anything that we can do to improve our service to you, we will listen.

Sincerely,



Sue W. Thomas | CHIEF EXECUTIVE OFFICER





## SPECIFICATION SUPPORT

By giving architects, designers and contractors open access to our expert team, we simplify the process of specifying and procuring access products from design through delivery and installation.

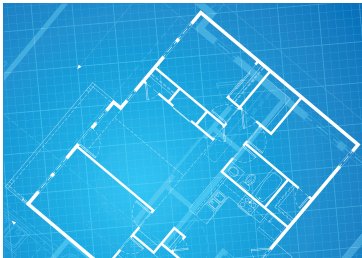

**DESIGN TOOLS**  
 **BIMsmith**  
 CAD  
 Shop Drawings



**SPEC AUTOMATION**  
 **RIB** formerly BSD  
**MasterSpec**  
 3-Part Specifications



**PRODUCT EXPERTS**  
 Design Engineer  
 Sales & Technical Support  
 Specification Consultants



**Approved  
 Continuing  
 Education**

**EDUCATION COURSES**  
 Roof Hatch & Smoke Vents



**DOCUMENTATION**  
 LEED/HPD  
 INSTALL & Operation Manual  
 Replacement Product  
 Warranty Support



**INSPIRATION**  
 Project Profiles & Gallery

# SYSTEM SELECTION GUIDE

A well designed system uses a two or three zone approach with a minimum of 18 feet of traffic length to stop 90% of dirt and moisture from infiltrating the building.

The main purpose of an entrance system is to stop dirt, sand and moisture at a building entrance; however, a well-designed system will both remove and retain debris.

## Exterior

The outside entrance requires an aggressive *scraping* product that requires as little maintenance as possible.

## Vestibule

Between the exterior and interior doors, choose a product that *scrapes* off soil and *absorbs* moisture.

## Interior

In lobby areas, nylon fibers offer optimal performance for additional moisture *absorption*.

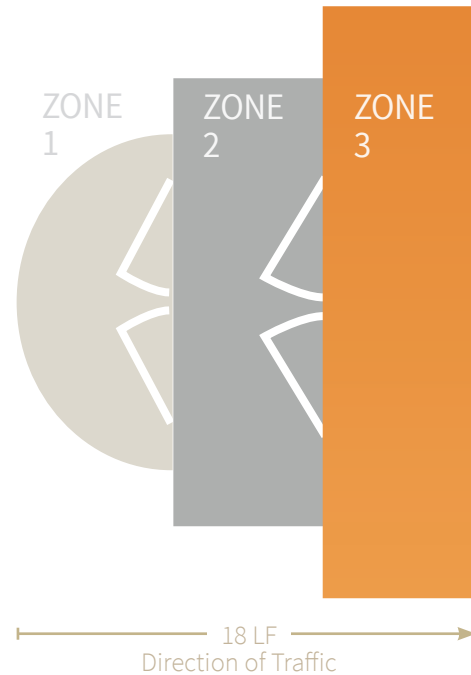

PRODUCT	TRAFFIC LOAD	DUAL TREAD OPTION	ZONE 1 <sup>†</sup> EXTERIOR	ZONE 2 VESTIBULE	ZONE 3 INTERIOR
MAXgrid™ Vinyl Mat	Medium - Heavy		●	●	●
MAXtread™ Vinyl Mat	Medium - Heavy		●	●	●
MATrac™ Roll-Up Mat	Light	●		●	●
MATdesign™ Roll-Up Mat	Light	●	●	●	●
QuietFLEX® Roll-Up Mat	Light	●	●	●	●
GRATEdesign® Roll-Up Grille	Medium	●	●	●	●
EnvIRONtreadII® Rigid Grille 	Light - Medium, Medium - Heavy			●	●
GRATEdesign® Rigid Grille	Heavy	●	●	●	●
GRATEdesign® Architectural Grille	Heavy		●	●	●
alumaGRIL™ Architectural Grille*	Medium - Heavy	●	●	●	●
eleGRIL® Stainless Steel Grille*	Light, Medium		●	●	●
proGRIL™ Architectural Grille*	Medium, Heavy		●	●	●

\*Not recommended for exterior snowy climates.

†Tread insert must also be rated for exterior use.

‡Dual tread available on plank and serrated only.

# USGBC LEED Credit Contributions

## ENTRANCE MATS + GRILLES



### MR CREDIT 4, RECYCLED CONTENT

Post-consumer + 1/2, Pre-consumer content

### MR CREDIT 5, REGIONAL MATERIAL

Use building materials or products that have been extracted, harvested or recovered, as well as manufactured, within 500 miles of the project site.

### MR CREDIT 5, RAPIDLY RENEWABLE MATERIALS

Use rapidly renewable building materials and products for 2.5% of the total value of all building materials and products used in the project, based on cost. Rapidly renewable building materials and products are made from agricultural products that are typically harvested within a 10-year or shorter cycle.

### IEQ CREDIT 4.3, LOW-EMITTING MATERIALS - FLOORING SYSTEMS

All carpet installed in the building interior must meet the testing and product requirements of the Carpet and Rug Institute Green Label Plus1 program. All carpet adhesives must meet the requirements of IEQ Credit 4.1: Adhesives and Sealants, which includes a volatile organic compound (VOC) limit of 50 g/L.

### IEQ CREDIT 5, POLLUTANT SOURCE CONTROL

Employ permanent entryway systems at least 10 feet long in the primary direction of travel to capture dirt and particulates entering the building at regularly used exterior entrances.

Acceptable entryway systems include: permanently installed grates, grilles and slotted systems that allow for cleaning underneath. Roll-out mats are acceptable only when maintained on a weekly basis by a contracted service organization.

To obtain IEQ Credit 5, Pollutant Source Control, the entrance flooring must be at least 10 feet long in the traffic direction, be permanently attached and be properly maintained in all high traffic entryways.

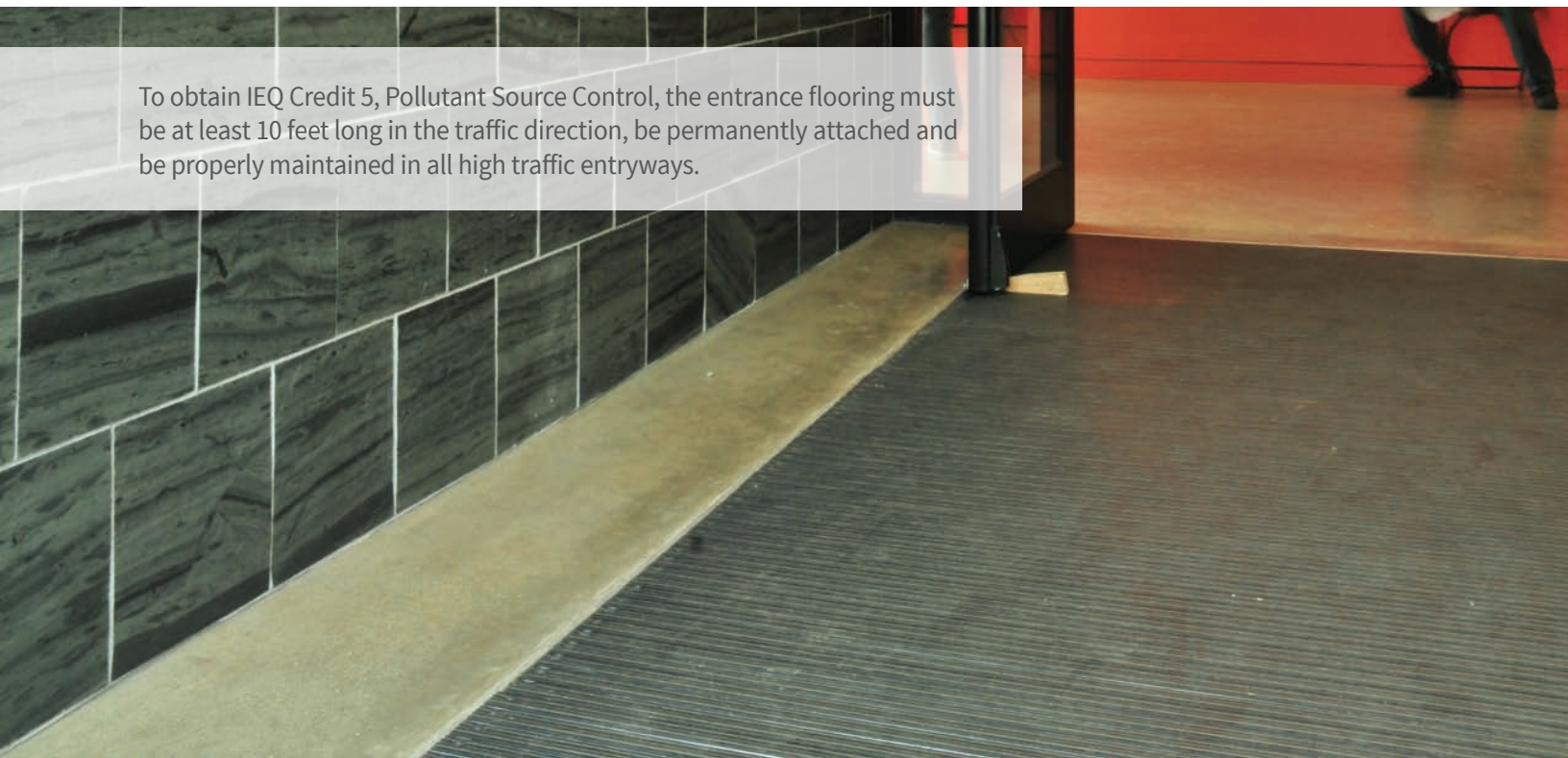



# proGRIL™

## STAINLESS STEEL ARCHITECTURAL GRILLE

Babcock-Davis' new stainless steel proGRIL offers top-of-the-line elegance and symmetry that will make a statement of grandeur in any entry.

### FEATURES

**PREMIER PRODUCT** Top-of-the-line stainless steel design for high-end buildings with entrances that make a statement of grandeur.

**MECHANICALLY INTERLOCKED** Design with a u-clip construction.

**ARCHITECTURAL CURVES** Available with optional curved wires for revolving doors and column designs.



ZONES  
1 + 2

### DETAILS

**MATERIAL** Stainless Steel, Type 304 or 316

**DEPTH** ¾ inch or 1-⅛ inch

**TREAD SPACING** .3275 inch on center

**TREAD DESIGN** .140 inch profile bar

**TREAD OPTIONS** Straight or Curved Wire

**FRAMES** Level Bed

**ROLLING LOAD** 500 lbs/wheel

### TREADS

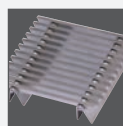

Straight  
Wire

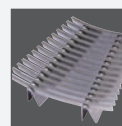

Curved  
Wire

### FRAMES

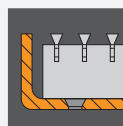

Level Bed,  
Mech. Fastened

### GRILLE

MODEL	TREAD	FUNCTION	DEPTH	TRAFFIC
BGP34S	Straight Wire	Scraping	¾"	Medium
BGP34C	Curved Wire	Scraping	¾"	Medium
BGP98S	Straight Wire	Scraping	1-⅛"	Heavy
BGP98C	Curved Wire	Scraping	1-⅛"	Heavy

### FRAME

MODEL	MOUNTING	MATERIAL	PROFILE	DEPTH
BFP34LBM	Level Bed, Mech. Fastened	Stainless Steel	⅛"	7⁄8"
BFP98LBM	Level Bed, Mech. Fastened	Stainless Steel	⅛"	1-¼"



# eleGRIL®

## STAINLESS STEEL GRILLE

Babcock-Davis' line of eleGRIL Stainless Steel Grilles are elegant and durable. This grille is most often used in high traffic venues as they stand up to extremely heavy pedestrian and rolling traffic.

### FEATURES

**GREAT SCRAPING ABILITY** The grille treads scrape off debris from foot wear, the particles drop through the rails and is captured beneath.

**WELDED V WIRE CONSTRUCTION** All eleGRIL grilles are electronically welded to ensure strength and durability.

**BEST FOR DRY AREAS** Metals become slippery when wet. These grilles should be specified for interiors only in snowy climates.

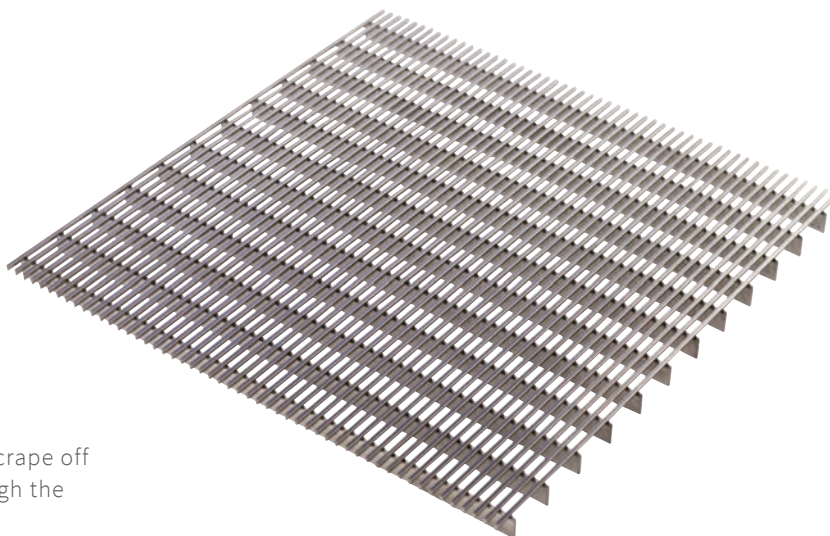

ZONES  
1 + 2

### DETAILS

**MATERIAL** Stainless Steel, Type 304 or 316

**DEPTH** 3/8 inch, 5/8 inch or 1-1/8 inch

**TREAD SPACING** .235 inch on center

**TREAD** .090 inch welded "v" wire

**FRAMES** Level Bed, Deep Pit or Surface Mount

**ROLLING LOAD** 1000 lbs/wheel

### TREADS

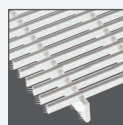

3/8 inch

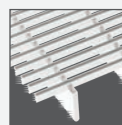

5/8 inch

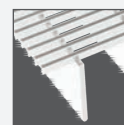

1-1/8 inch

### FRAMES

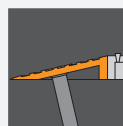

Surface

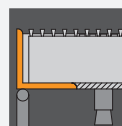

Level Bed,  
Cast-In

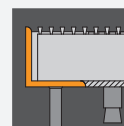

Level Bed,  
Mech. Fastened

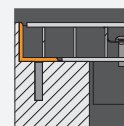

Deep Pit,  
Mech. Fastened

### GRILLE

MODEL	TREAD	FUNCTION	DEPTH	TRAFFIC
BGE38H	Stainless Steel	Scraping	3/8"	Low
BGE58H	Stainless Steel	Scraping	5/8"	Medium
BGE98H	Stainless Steel	Scraping	1-1/8"	Heavy

### FRAME

MODEL	MOUNTING	MATERIAL	PROFILE	DEPTH
BFE38HSAM	Surface	Aluminum	1-5/8"	15/32"
BFE38HLBC	Level Bed, Cast-In	Stainless Steel	1/8"	9/16"
BFE38HLBM	Level Bed, Mech. Fastened	Stainless Steel	1/8"	9/16"
BFE58HLBC	Level Bed, Cast-In	Stainless Steel	1/8"	3/4"
BFE58HLBM	Level Bed, Mech. Fastened	Stainless Steel	1/8"	3/4"
BFE98HLBC	Level Bed, Cast-In	Stainless Steel	1/8"	1-1/4"
BFE98HLBM	Level Bed, Mech. Fastened	Stainless Steel	1/8"	1-1/4"
BFE98HDAM	Deep Pit, Mech. Fastened*	Stainless Steel	1/8"	3" - 7"

# alumaGRIL™

## ARCHITECTURAL GRILLE

Babcock-Davis' all aluminum Architectural Grille adds a sleek, clean and modular look to entrances. At a fraction of the price of stainless steel entrance grilles, these modular sections add style to any entrance.



### FEATURES

**ARCHITECTURAL BEAUTY** Design a breathtaking entrance at a fraction of the cost of stainless steel.

**EASY INSTALLATION** Installation is a breeze as no tie downs are required. Simply place the modular sections into the frame.

**MODULAR SECTIONS** Each section is framed for a stylish, modern design.

ZONES  
1 - 3

### DETAILS

**MATERIAL** Aluminum

**DEPTH** 1 inch

**TREAD SPACING** 3/16 inch between treads

**TREAD DESIGN** Waffle, Plank, Rectangular, Serrated or Bar

**FRAMES** Level Bed or Deep Pit

**ROLLING LOAD** 1200 lbs/wheel\*

\*Maximum grille section is 48 inches by 48 inches.

### GRILLE

MODEL	TREAD	FUNCTION	DEPTH	TRAFFIC
BGL10P	1/2" Plank	Scraping	1"	Medium to Heavy
BGL10S	1/2" Serrated Plank	Scraping	1"	Medium to Heavy
BGL10W	1/2" Waffle	Scraping	1"	Medium to Heavy
BGL10R	1/2" Rectangle	Scraping	1"	Medium to Heavy
BGL10B	3/16" Bar	Scraping	1"	Medium to Heavy

### FRAME

MODEL	MOUNTING	MATERIAL	PROFILE	DEPTH
BFL10LBC	Level Bed, Cast-In	Aluminum	3/8"	1-1/8"
BFL10LBM	Level Bed, Mech. Fastened	Aluminum	3/8"	1-1/8"

### TREADS

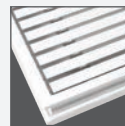

Plank



Waffle

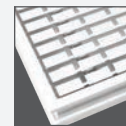

Rectangle

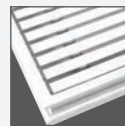

Serrated

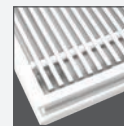

Bar

### FRAMES

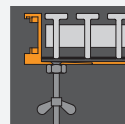

Level Bed,  
Cast-In

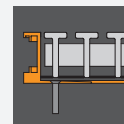

Level Bed,  
Mech. Fastened

# GRATEdesign®

## ARCHITECTURAL GRILLE

Babcock-Davis' GRATEdesign Aluminum Architectural Grille offers a serrated tread that looks sleek and offers slip resistance.



1-1/2" serrated tread shown

### FEATURES

**STRONG AND SILENT** This durable grille is constructed with I-beams for added strength and cushions to deaden sound.

**STOP THE DIRT AT THE DOOR** Protect your building floors from dirt and moisture with the use of entrance mats and grilles.

**GREAT SCRAPING ABILITY** The serrated treads scrape off debris from foot wear, the particles drop between the rails and are captured beneath.

ZONES  
1 - 3

### DETAILS

**MATERIAL** Aluminum

**DEPTH** 1-3/4 inch

**TREAD SPACING** 1-1/2 Width: 1-1/2 inch on center

**TREAD OPTION** 1-1/2 inch

**FRAMES** Level Bed or Deep Pit

**ROLLING LOAD** 1000 lbs/wheel

### FRAMES

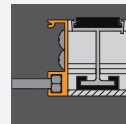

Level Bed,  
Cast-In

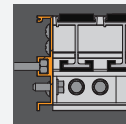

3 inch Deep Pit,  
Cast-In

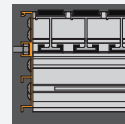

4 inch Deep Pit,  
Cast-In

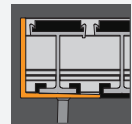

Level Bed,  
Mech. Fastened

### GRILLE

MODEL	TREAD	FUNCTION	DEPTH	TRAFFIC
BGD74A	1-3/4" Serrated Aluminum	Scraping	1-3/4"	Heavy

### FRAME

MODEL	MOUNTING	MATERIAL	PROFILE	DEPTH
BFD74LBC	Level Bed, Cast-In	Aluminum	1/2"	1-7/8"
BFD74D4C	Deep Pit, Cast-In	Aluminum	1/2"	1-3/4"
			1/2"	4-1/4" pit
BFD74D3C	Deep Pit, Cast-In	Aluminum	1/2"	2-13/16"
			1/2"	3" pit
BFD74LBM	Level Bed, Mech. Fastened	Aluminum	1/8"	1-7/8"



# GRATEdesign®

## RIGID GRILLE

Babcock-Davis' GRATEdesign Rigid Grille is sturdy and offers design flexibility and is effective in any type of high-traffic entrance.

### FEATURES

**DUAL TREADS** The only grille in the industry to offer the design flexibility to mix and match treads.

**STRONG AND SILENT** This durable grille is constructed with I-beams for added strength and cushions to deaden sound.

**STOP THE DIRT AT THE DOOR** Protect your building floors from dirt and moisture with the use of entrance mats and grilles.



Dual tread with premium carpet and vinyl shown

ZONES  
1 - 3

### DETAILS

**MATERIAL** Aluminum

**DEPTH** 1-¾ inch

**TREAD SPACING** 1-½ inch on center

**TREAD OPTIONS** Single or Dual

**FRAMES** Level Bed or Deep Pit

**ROLLING LOAD** 1000 lbs/wheel

### GRILLE

MODEL	TREAD	FUNCTION	DEPTH	TRAFFIC
BGD74P	Premium Carpet	Absorbent & Scraping	1-¾"	Heavy
BGD74R	Rugged Scrub	Scraping	1-¾"	Heavy
BGD74V	Vinyl	Scraping	1-¾"	Heavy
BGD74U	Ribbed Rubber	Scraping	1-¾"	Heavy
BGD74E	EcoTread	Slip Resistant	1-¾"	Heavy
BGD74G	Vinyl Abrasive	Slip Resistant	1-¾"	Heavy
BGD74B	Brush	Scraping	1-¾"	Heavy

### FRAME

MODEL	MOUNTING	MATERIAL	PROFILE	DEPTH
BFD74LBC	Level Bed, Cast-In	Aluminum	½"	1-7/8"
BFD74D4C	Deep Pit, Cast-In	Aluminum	½"	1-¾"
			½"	4-¼" pit
BFD74D3C	Deep Pit, Cast-In	Aluminum	½"	2-13/16"
			½"	3" pit
BFD74LBM	Level Bed, Mech. Fastened	Aluminum	½"	1-7/8"

### TREAD INSERTS



Premium Carpet

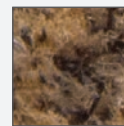

Rugged Scrub®

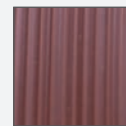

Vinyl

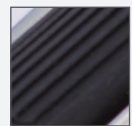

Ribbed Rubber



EcoTread™



Vinyl Abrasive Insert

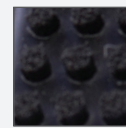

Brush

### FRAMES

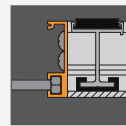

Level Bed, Cast-In

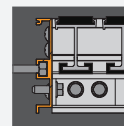

3 inch Deep Pit, Cast-In

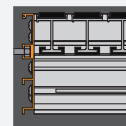

4 inch Deep Pit, Cast-In

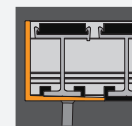

Level Bed, Mech. Fastened

# EnvIRONtreadII®

## RIGID GRILLE

Babcock-Davis' EnvIRONtreadII Rigid Grille is constructed of recycled, reversible, and sustainable materials and is effective in any type of high-traffic entrance.

### FEATURES

**RECYCLED** Minimum of 59% post-consumer and 29% of pre-consumer recycled content. Buffed nylon-reinforced truck and airplane tire strips.

**REVERSIBLE** Double sided treads make symmetrical grilles perfectly reversible. Just flip over to increase product life.

**RELIABLE** Buffing the fibers out of used tires creates tread strips with an attractive velvety surface that allows the inserts to maintain their new appearance over time.



Single tread, open construction shown

Interior Only

ZONES  
2 - 3

### DETAILS

**MATERIAL** Aluminum

**DEPTH** 1<sup>1</sup>/<sub>16</sub> inch or 1<sup>5</sup>/<sub>32</sub> inch

#### TREAD SPACING

- Single Tread: 1-1<sup>1</sup>/<sub>8</sub> inch on center
- Double Tread: 1-1<sup>1</sup>/<sub>16</sub> inch on center

**TREAD OPTIONS** Open (punched) or Closed

**FRAMES** Level Bed or Surface Mount

**ROLLING LOAD** 1500 lbs/wheel

### TREAD OPTIONS

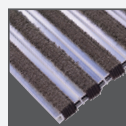

Single Closed Tread

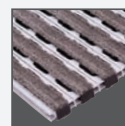

Single Open Tread

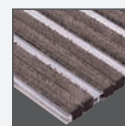

Double Closed Tread

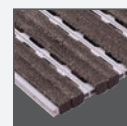

Double Open Tread

### FRAMES

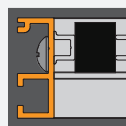

Level Bed, Cast-In

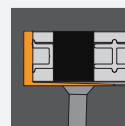

Level Bed, Mech. Fastened

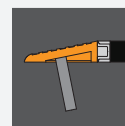

Surface Mount, Mech. Fastened

### GRILLE

MODEL	TREAD	FUNCTION	DEPTH	TRAFFIC
BGV34	envIRONtreadII®	Absorbent & Scraping	1 <sup>1</sup> / <sub>16</sub> "	Medium to Heavy
BGV12	envIRONtreadII®	Absorbent & Scraping	1 <sup>5</sup> / <sub>32</sub> "	Light to Medium

### FRAME

MODEL	MOUNTING	MATERIAL	PROFILE	DEPTH
BFV34LBC	Level Bed, Cast-In	Aluminum	1/2"	1-3/8"
BFV34LBM	Level Bed, Mech. Fastened	Aluminum	1/8"	3/4"
BFV12LBC	Level Bed, Cast-In	Aluminum	1/8"	5/8"
BFV12SAM	Surface Mount, Mech. Fastened	Aluminum	1-5/8"	1 <sup>5</sup> / <sub>32</sub> "

# GRATEdesign®

## ROLL-UP GRILLE

Babcock-Davis' GRATEdesign roll-up grille is constructed of hollow extrusion rails joined by low-density polyethylene (LDPE) hinge. The cushion retained in the captive aluminum tread port, along with drainage holes, allows debris and moisture to flow through the grille.

### FEATURES

**DUAL TREADS FOR DUAL PURPOSE** Now offering the design flexibility to mix and match treads. Simply select treads for absorption, scraping or slip resistance.

**PVC FREE HINGES** Our PVC free, LDPE hinges raise the industry bar for performance in both flexibility and durability. Insist on LDPE hinges!

**ROLL BACK FOR EASY CLEANING** Easily maintain your entry system by rolling back the grille for regular sweeping or vacuuming to extend the life of your system.

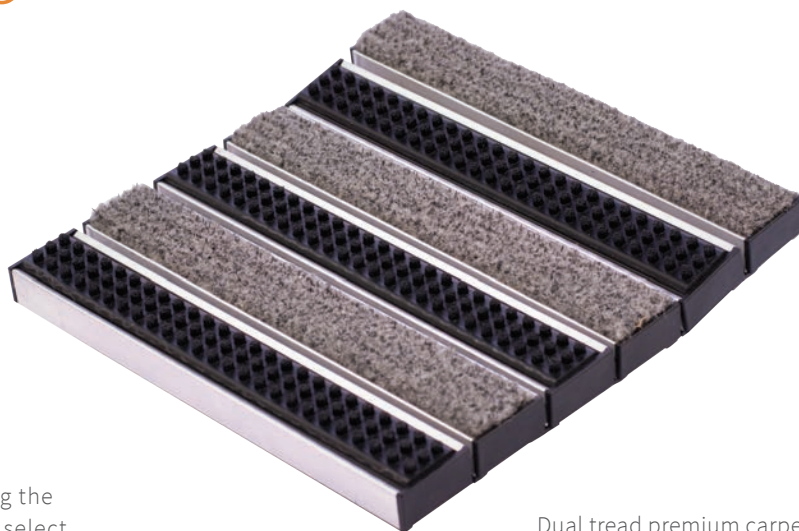

Dual tread premium carpet and brush shown

ZONES  
1 - 3

### DETAILS

**RAIL MATERIAL** Aluminum

**DEPTH** ¾ inch

**TREAD SPACING** 1-½ inches on center

**TREAD OPTIONS** Single or Dual

**FRAMES** Level Bed

**ROLLING LOAD** 1000 lbs/wheel

### GRILLE

MODEL	TREAD	FUNCTION	DEPTH	TRAFFIC
BGR34P	Premium Carpet	Absorbent & Scraping	¾"	Medium
BGR34R	Rugged Scrub	Scraping	¾"	Medium
BGR34V	Vinyl	Scraping	¾"	Medium
BGR34U	Ribbed Rubber	Scraping	¾"	Medium
BGR34E	EcoTread	Slip Resistant	¾"	Medium
BGR34G	Vinyl Abrasive	Slip Resistant	¾"	Medium
BGR34B	Brush	Scraping	¾"	Medium

### FRAME

MODEL	MOUNTING	MATERIAL	PROFILE	DEPTH
BFR34LBC	Level Bed, Cast-In	Aluminum	½"	1-¾"
BFR34LBM	Level Bed, Mech. Fastened	Aluminum	⅝"	¾"

### TREAD INSERTS



Premium Carpet

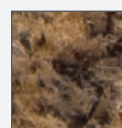

Rugged Scrub®

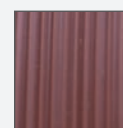

Vinyl

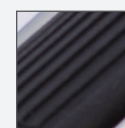

Ribbed Rubber

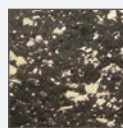

EcoTread™



Vinyl Abrasive Insert

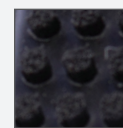

Brush

### FRAMES

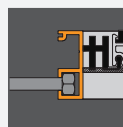

Level Bed,  
Cast-In

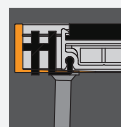

Level Bed,  
Mech. Fastened



# QuietFLEX®

## ROLL-UP MAT

Babcock-Davis' QuietFLEX roll-up mat is constructed of LDPE hinges to reduce traffic noise. The lightweight aluminum rails make this mat easy to roll back for routine maintenance.



Dual tread rugged scrub and serrated aluminum shown

ZONES  
1 - 3

### FEATURES

**DESIGNED TO BE QUIET** Lightweight rails, LDPE hinges and a wide range of tread insert options make this an ideal mat for any interior entry with light to medium traffic.

**ROLL BACK FOR EASY CLEANING** Proper maintenance extends the life of your entry system. Regular vacuuming is necessary for all 3/8 inch deep mats.

**DUAL TREADS FOR DUAL PURPOSE** Now offering the design flexibility to mix and match treads. Simply select treads for absorption, scraping or slip resistance.

### DETAILS

**MATERIAL** Aluminum

**DEPTH** 3/8 inch

**TREAD SPACING** 2 inches on center

**TREAD OPTIONS** Single or Dual

**FRAMES** Level Bed or Surface Mount

**ROLLING LOAD** 300 lbs/wheel

### MAT

MODEL	TREAD	FUNCTION	DEPTH	TRAFFIC
BMQ38P	Premium Carpet	Absorbent & Scraping	3/8"	Light
BMQ38R	Rugged Scrub	Scraping	3/8"	Light
BMQ38V	Vinyl	Scraping	3/8"	Light
BMQ38U	Ribbed Rubber	Scraping	3/8"	Light
BMQ38E	EcoTread	Slip Resistant	3/8"	Light
BMQ38G	Vinyl Abrasive	Slip Resistant	3/8"	Light
BMQ38A	Serrated Aluminum	Scraping	3/8"	Light
BMQ38B	Brush	Scraping	3/8"	Light

### FRAME

MODEL	MOUNTING	MATERIAL	PROFILE	DEPTH
BFQ38LBC	Level Bed, Cast-In	Aluminum	1/2"	1-3/8"
BFQ38SAM	Surface Mount, Mech. Fastened	Aluminum	1-5/8"	3/8"
BFQ38SV	Surface Mount, Mat Attached	Vinyl	1-5/8"	3/8"
BFQ38LBM	Level Bed, Mech. Fastened	Aluminum	1/8"	7/16"

### TREAD INSERTS

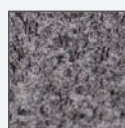

Premium Carpet

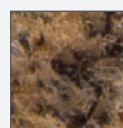

Rugged Scrub®

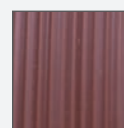

Vinyl



Ribbed Rubber

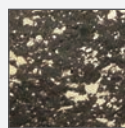

EcoTread™



Vinyl Abrasive Insert

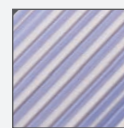

Serrated Aluminum

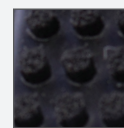

Brush

### FRAMES

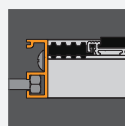

Level Bed, Cast-In



Surface Mount, Mech. Fastened



Surface, Mat Attached

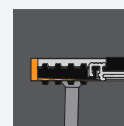

Level Bed, Mech. Fastened

# MATdesign®

## ROLL-UP MAT

Babcock-Davis' MATdesign Roll-Up Mat is engineered with aluminum rails, ball and socket aluminum hinges and drain holes to allow debris and moisture to flow through the mat.

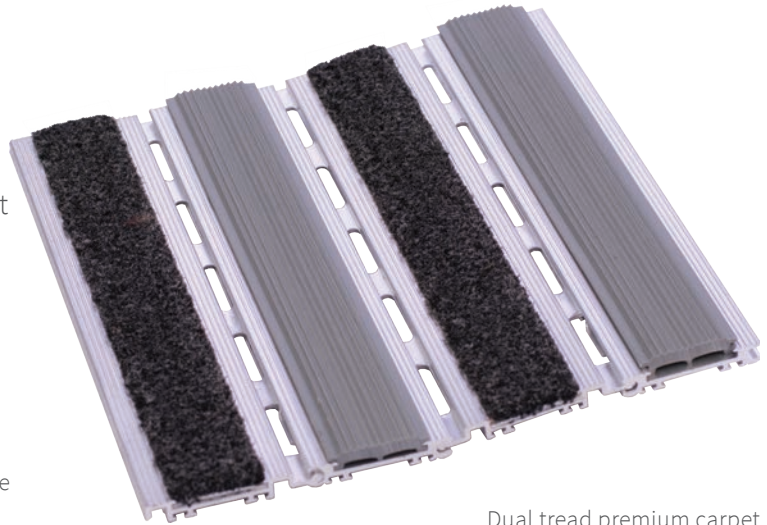

### FEATURES

**ECONOMICAL** Strong, durable aluminum rails offer a long-lasting entrance flooring solution at an affordable price.

**DUAL TREADS FOR DUAL PURPOSE** Now offering the design flexibility to mix and match treads. Simply select treads for absorption, scraping or slip resistance.

**ROLL BACK FOR EASY CLEANING** Proper maintenance extends the life of your entry system. Regular vacuuming is necessary for all  $\frac{3}{8}$  inch deep mats.

Dual tread premium carpet and vinyl shown

ZONES  
1 - 3

### DETAILS

**MATERIAL** Aluminum

**DEPTH**  $\frac{3}{8}$  inch

**TREAD SPACING** 2 inches on center

**FRAMES** Level Bed or Surface Mount

**ROLLING LOAD** 350 lbs/wheel

### MAT

MODEL	TREAD	FUNCTION	DEPTH	TRAFFIC
BMD38P	Premium Carpet	Absorbent & Scraping	$\frac{3}{8}$ "	Light
BMD38R	Rugged Scrub	Scraping	$\frac{3}{8}$ "	Light
BMD38V	Vinyl	Scraping	$\frac{3}{8}$ "	Light
BMD38U	Ribbed Rubber	Scraping	$\frac{3}{8}$ "	Light
BMD38E	EcoTread	Slip Resistant	$\frac{3}{8}$ "	Light
BMD38G	Vinyl Abrasive	Slip Resistant	$\frac{3}{8}$ "	Light
BMD38B	Brush	Scraping	$\frac{3}{8}$ "	Light

### FRAME

MODEL	MOUNTING	MATERIAL	PROFILE	DEPTH
BFD38LBC	Level Bed, Cast-In	Aluminum	$\frac{1}{2}$ "	1- $\frac{3}{8}$ "
BFD38SAM	Surface Mount, Mech. Fastened	Aluminum	1- $\frac{5}{8}$ "	$\frac{3}{8}$ "
BFD38LBM	Level Bed, Mech. Fastened	Aluminum	$\frac{1}{8}$ "	$\frac{7}{16}$ "

### TREAD INSERTS



Premium Carpet



Rugged Scrub®

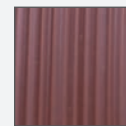

Vinyl

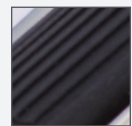

Ribbed Rubber



EcoTread™



Vinyl Abrasive Insert

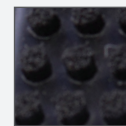

Brush

### FRAMES

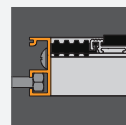

Level Bed, Cast-In



Surface Mount, Mech. Fastened

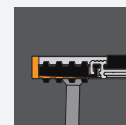

Level Bed, Mech. Fastened

# MATrac™

## ROLL-UP MAT

Babcock-Davis' new sleek vinyl roll-up mat is the most economical to the market. Ideal for low traffic and retrofit applications, this lightweight mat is a perfect solution for tight budgets.

### FEATURES

**LIGHTWEIGHT & EASY INSTALLATION** The mat is lightweight and can easily be installed by one person, making the process quick and practically pain-free.

**SIMPLE, ELEGANT DESIGN** The streamlined black rails add a touch of refinement at an affordable price.

**DUAL TREADS FOR DUAL PURPOSE** Now offering the design flexibility to mix and match treads. Simply select treads for absorption, scraping or slip resistance.

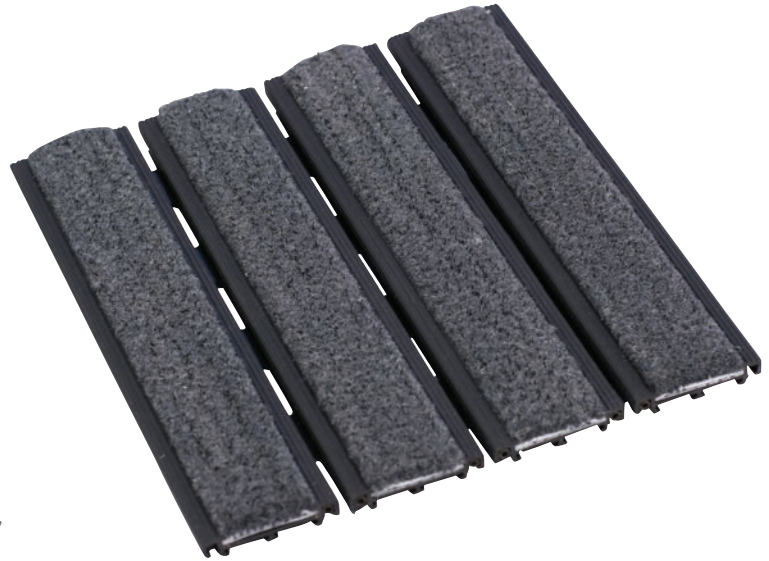

Interior Only

ZONES  
2 - 3

### DETAILS

**MATERIAL** Vinyl

**DEPTH** 3/8 inch

**TREAD SPACING** 1-7/8 inch on center

**FRAMES** Level Bed or Surface Mount

**ROLLING LOAD** 350 lbs/wheel

### MAT

MODEL	TREAD	FUNCTION	DEPTH	TRAFFIC
BMT38P	Premium Carpet	Absorbent & Scraping	3/8"	Light
BMT38R	Rugged Scrub	Scraping	3/8"	Light
BMT38U	Ribbed Rubber	Scraping	3/8"	Light
BMT38E	EcoTread	Slip Resistant	3/8"	Light
BMT38G	Vinyl Abrasive	Slip Resistant	3/8"	Light
BMT38B	Brush	Scraping	3/8"	Light

### FRAME

MODEL	MOUNTING	MATERIAL	PROFILE	DEPTH
BFT38SV	Surface	Vinyl	1-5/8"	3/8"
BFT38SAM	Surface	Aluminum	1-5/8"	3/8"
BFT38LBC	Level Bed	Aluminum	1/2"	1-3/8"
BFT38LBM	Level Bed, Mech. Fastened	Aluminum	1/8"	7/16"

### TREAD INSERTS



Premium Carpet

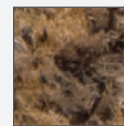

Rugged Scrub®

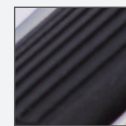

Ribbed Rubber



EcoTread™



Vinyl Abrasive Insert

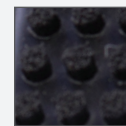

Brush

### FRAMES

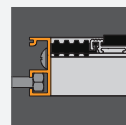

Level Bed, Cast-In



Surface Mount, Mech. Fastened



Surface, Mat Attached

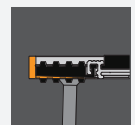

Level Bed, Mech. Fastened



# MAXtread™

## VINYL MAT

Babcock-Davis' new MAXtread is a flexible, open weave, vinyl mat with carpet inlays. This system will trap dirt, snow and sand while retaining the debris within the grid and can be easily rolled back for cleaning. Ideal for retail applications with heavy pedestrian traffic.

### FEATURES

**HINGE-FREE, NOISE-FREE** The injection molded mats are fused together to form a flexible mat. The flexible PVC can be rolled back for easy cleaning.

**PATENTED HOLD-DOWN SYSTEM** The mats are secured in place with a unique, hidden, retainer system. Engineered for easy installation and removal for cleaning.

**HEAVY-DUTY, HIGH TRAFFIC** The combination of the deep well, and the open weave design, creates a large debris collection area; necessary for high pedestrian traffic.



ZONES  
1 - 3

### DETAILS

**MATERIAL** Vinyl

**DEPTH** ½ inch

**TREAD SPACING** 2-¼ inches on center

**TREAD OPTIONS** Polypropylene Carpet with hook and loop (replaceable) or glued (permanent) attachment

**FRAME** Level Bed or Surface Mount

**ROLLING LOAD** 1200 lbs/wheel

### MAT

MODEL	TREAD	FUNCTION	DEPTH	TRAFFIC
BMX12H	Poly Carpet, Hook & Loop*	Scraping	½"	Medium to Heavy
BMX12Z	Poly Carpet, Glued	Scraping	½"	Medium to Heavy

\*Replaceable carpet

### FRAME

MODEL	MOUNTING	MATERIAL	PROFILE	DEPTH
BFX12SV	Surface	Vinyl	2-¾"	½"
BFX12SAM	Surface	Aluminum	2"	½"
BFX12LCH	Level Bed, Mech. Fastened Channel	Aluminum	¾"	½"
BFX12LTR	Level Bed, Mech. Fastened Transition	Aluminum	1"	½"
BFX12LTO	Level Bed, Mech. Fastened Transition with Overhang	Aluminum	1"	½"

### TREADS



Glued  
(Permanent)



Hook & Loop  
(Replaceable)

### ATTACHMENT



Lock Down  
Clips

### FRAMES

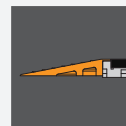

Surface,  
Vinyl

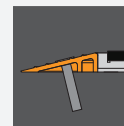

Surface,  
Aluminum

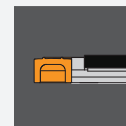

Level Bed,  
Mech. Fastened  
Channel

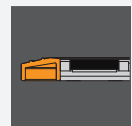

Level Bed,  
Mech. Fastened  
Transition

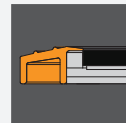

Level Bed, Mech. Fastened  
Transition with Overhang

# MAXgrid™

## VINYL MAT

Babcock-Davis' new MAXgrid is a flexible, open weave, vinyl mat. The patented grid rib system is heel resistant. This system will trap dirt and sand while retaining the debris within the grid. Easily roll back the mat for cleaning. Ideal for retail applications with heavy pedestrian traffic.

### FEATURES

**HINGE-FREE, NOISE-FREE** The injection molded mats are fused together to form a flexible mat. The flexible PVC can be rolled back for easy cleaning.

**PATENTED HOLD-DOWN SYSTEM** The mats are secured in place with a unique, hidden, retainer system. Engineered for easy installation and removal for cleaning.

**HEAVY-DUTY, HIGH TRAFFIC** The combination of the deep well, and the open weave design, creates a large debris collection area; necessary for high pedestrian traffic.

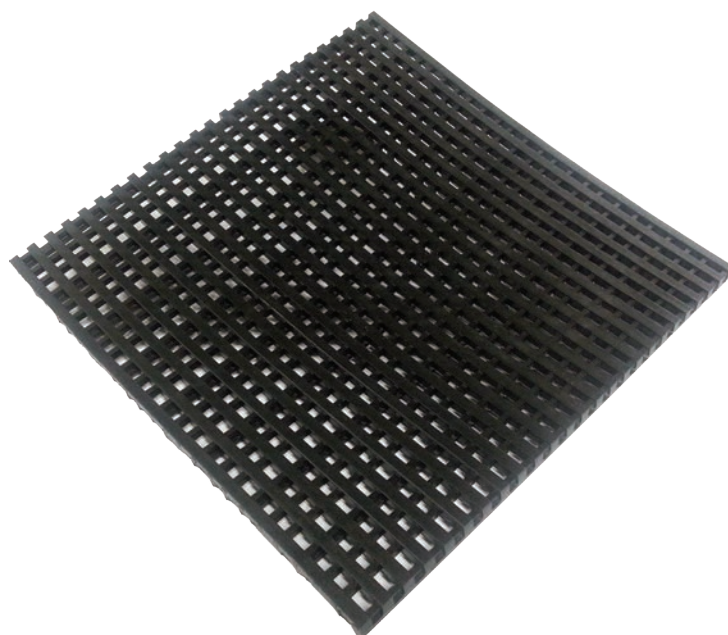

ZONES  
1 - 3

### DETAILS

**MATERIAL** Vinyl

**DEPTH** ½ inch

**TREAD SPACING** ¾ inch on center

**TREAD OPTIONS** Vinyl Rails

**FRAME** Level Bed or Surface Mount

**ROLLING LOAD** 1200 lbs/wheel

### MAT

MODEL	TREAD	FUNCTION	DEPTH	TRAFFIC
BMG12	Vinyl	Scraping	½"	Medium to Heavy

### FRAME

MODEL	MOUNTING	MATERIAL	PROFILE	DEPTH
BFG12SV	Surface	Vinyl	2-¾"	½"
BFG12SAM	Surface	Aluminum	2"	½"
BFG12LCH	Level Bed, Mech. Fastened Channel	Aluminum	¾"	½"
BFG12LTR	Level Bed, Mech. Fastened Transition	Aluminum	1"	½"
BFG12LTO	Level Bed, Mech. Fastened Transition with Overhang	Aluminum	1"	½"

### ATTACHMENT



Lock Down  
Clips

### FRAMES

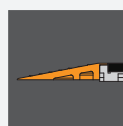

Surface,  
Vinyl

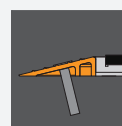

Surface,  
Aluminum

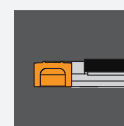

Level Bed,  
Mech. Fastened  
Channel



Level Bed,  
Mech. Fastened  
Transition

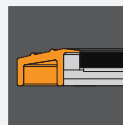

Level Bed, Mech. Fastened  
Transition with Overhang

# Color Anodizing

Color anodizing is available for all aluminum frames and for the following aluminum rails: GRATEdesign, MATdesign, QuietFLEX and alumaGRIL.

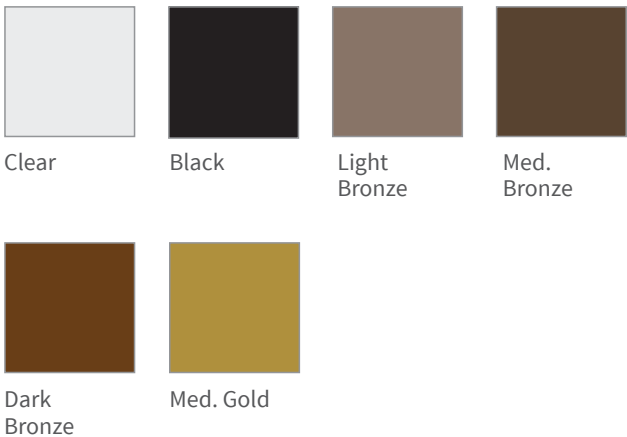

# Dual Treads

Babcock-Davis now offers dual treads on select mats and grilles. Dual treads offer design flexibility to mix and match treads, and to offer both absorbent and scraping treads in one system.

## AVAILABLE SYSTEMS INCLUDE

- GRATEdesign® Rigid Grille
- GRATEdesign® Roll-Up Grille
- QuietFLEX® Roll-Up Mat
- MATdesign™ Roll-Up Mat
- MATrac™ Roll-Up Mat

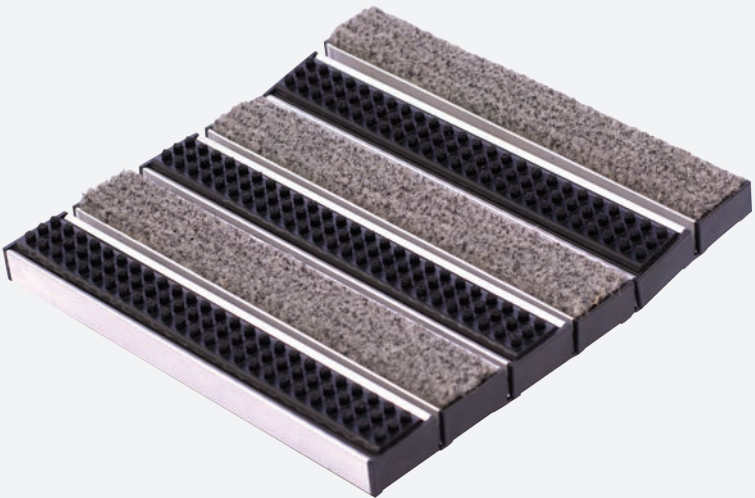

PRIMARY TREAD	SECOND TREAD
<b>PREMIUM CARPET</b>	EcoTread Vinyl Ribbed Rubber Abrasive Insert Serrated Aluminum* Brush
<b>RUGGED SCRUB</b>	EcoTread Vinyl Ribbed Rubber Abrasive Insert Serrated Aluminum* Brush

\*Not available for MATdesign Roll-Up Mat and GRATEdesign Roll-Up Grille.



# Premium Carpet

## COLOR OPTIONS



Sandbar



Espresso



Smoke



Slate



Chrome

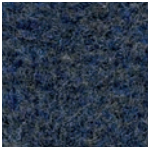

Denim



Wrought Iron



Castle Gray



Gun Metal

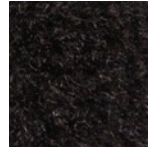

Graphite



Fern

Babcock-Davis uses the highest-quality carpet available for our mats and grilles.

**CONSTRUCTION** Carpet fibers are 3700 denier solution-dyed woven nylon and shall include a minimum of 100 10 ml mono filament fibers per square inch. Carpet weight shall be 33 oz. per square yard.

APPLICATION	FUNCTION
INTERIOR	Absorbent & Scraping

# Rugged Scrub®

## COLOR OPTIONS



Chocolate Chip



Charcoal



Tan



Licorice

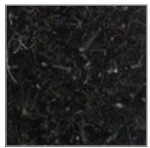

Black

This rugged carpet alternative is perfect for heavy-duty applications, is easy to maintain and the ideal solution for exterior and interior applications.

**CONSTRUCTION** 600 denier, solution-dyed polypropylene, tufted.

APPLICATION	FUNCTION
INTERIOR/EXTERIOR	Absorbent & Scraping

# EcoTread™

## COLOR OPTIONS



Midnight Black



Milky Way

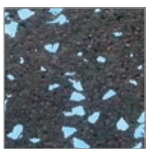

Blue Night

Recycled rubber with EPDM backing. Provides a minimum of 64% post-consumer, 5.5% pre-consumer recycled content.

**STANDARD COLOR** Midnight black

APPLICATION	FUNCTION
INTERIOR/EXTERIOR	Slip Resistant

Colors shown give only an indication of shade. Samples are available upon request

# EnvIRONtreadII®

## COLOR OPTIONS

Constructed of truck and airplane tire strips, EnvIRONtreadII lasts longer than other textile entrance mats and grilles.

**STANDARD COLOR** Gray. Black may carry an additional charge.

**NOTE** Due to the recycled contents, there may be a significant color variation in this product.

APPLICATION	FUNCTION
INTERIOR	Absorbent & Scraping

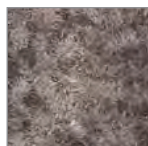

Gray



Black

# Ribbed Rubber

## COLOR OPTIONS

The new dual durometer, TPV rubber tread is ideal for interior/exterior areas where moisture absorbency is not required.

**CONSTRUCTION** Vinyl base and a TPV, PVC-free, convex shaped tread with continuous serrations.

APPLICATION	FUNCTION
INTERIOR/EXTERIOR	Scraping



Black

# Vinyl

## COLOR OPTIONS

Use vinyl in high-traffic, interior areas where moisture absorbency is not required.

**CONSTRUCTION** Extruded vinyl convex shape, continuous serrations.

APPLICATION	FUNCTION
INTERIOR/EXTERIOR	Scraping

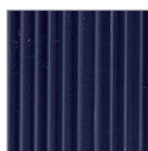

Blue



Gray



Beige



Red



Dark Brown



Black

# Abrasive Insert

## COLOR OPTIONS

Use abrasive inserts in interior areas where slip resistance is critical.

**CONSTRUCTION** Flexible abrasive bonded to a rigid bio-based/recycled plastic tread insert.

APPLICATION	FUNCTION
INTERIOR	Slip Resistant

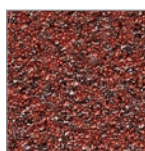

Brick Red



Dark Brown

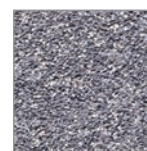

Ocean Gray

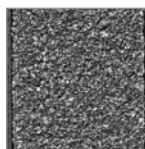

Safety Yellow

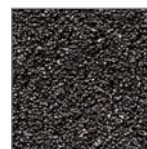

Flat Black

# Serrated Aluminum

## COLOR OPTIONS

Use serrated aluminum in interior areas where scraping is critical.

**CONSTRUCTION** Serrated aluminum, mill finish.

APPLICATION	FUNCTION
INTERIOR/EXTERIOR	Scraping

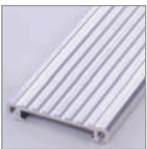

Mill

# Brush

## COLOR OPTIONS

Babcock-Davis' new rugged, brush is a premier scraping tread, ideal for snowy northern climates.

**CONSTRUCTION** Brush tread insert is constructed of rigid nylon bristles, 9 tufts per inch, each tuft contains 80 bristles.

APPLICATION	FUNCTION
INTERIOR/EXTERIOR	Scraping



Black

# Polyester Carpet

## COLOR OPTIONS

For MAXtread systems only. Use polyester carpet in interior or exterior areas where moisture removal and scraping is critical.

**CONSTRUCTION** Crimped solution-dyed 2750 denier polypropylene fibers tufted into a woven double backing and glued tread rails. Carpet weigh shall be 26 oz./yd<sup>2</sup>.

APPLICATION	FUNCTION
INTERIOR/ EXTERIOR	Absorbent & Scraping



Black



Gray



Brown

# Vinyl Mat

## COLOR OPTIONS

Use vinyl grilles in interior areas where scraping is critical.

**CONSTRUCTION** Injection molded Polyvinyl Chloride (PVC).

APPLICATION	FUNCTION
INTERIOR/EXTERIOR	Scraping

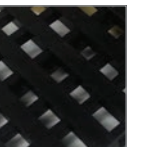

Black

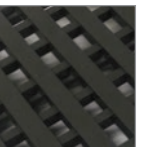

Gray

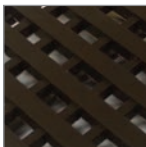

Brown

Colors shown give only an indication of shade. Samples are available upon request



A black and white photograph of two men in business casual attire shaking hands in a modern office environment with large windows in the background. A large, dark, diagonal graphic element is overlaid on the left side of the image.

Great Products.  
Better Partners.



9300 73RD AVENUE NORTH  
BROOKLYN PARK, MN 55428

(888) 412-3726  
(866) 916-6672 FAX

[INFO@BABCOCKDAVIS.COM](mailto:INFO@BABCOCKDAVIS.COM)

[BABCOCKDAVIS.COM](http://BABCOCKDAVIS.COM)

