

SECTION A-A

SECTION B-B

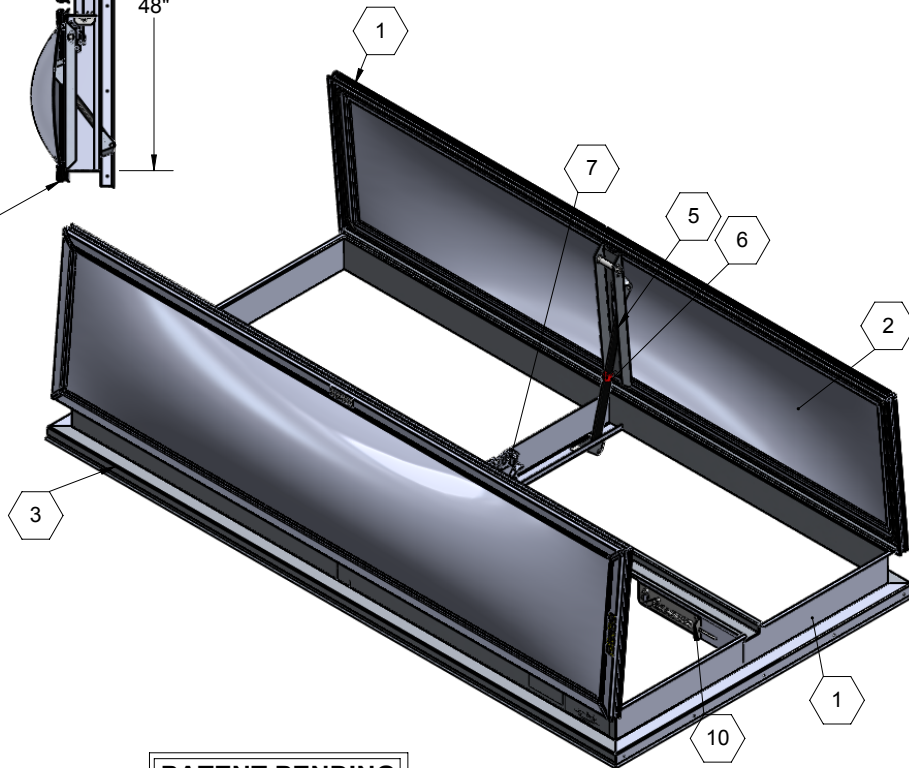
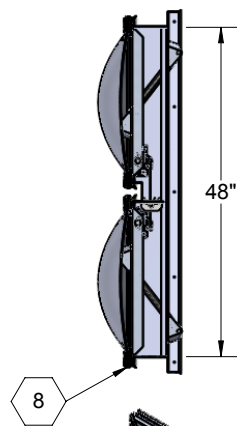

**SPECIFICATIONS:**

- ① **COVER:** ALUMINUM COVER TO WITHSTAND A LIVE LOAD OF 40 PSF
- ② **TRANSLUCENT MATERIAL:** POLYCARBONATE, WHITE DOME
- ③ **CURB** 11 GAUGE ALUMINUM
- ④ **FINISH:** COVER - MILL  
CURB - MILL
- ⑤ **GAS SPRING WITH DAMPER:** DESIGNED TO OPEN AGAINST A 10PSF SNOW LOAD IN NOT LESS THAN 2 SECONDS
- ⑥ **HOLD OPEN ARM:** LOCK COVER IN FULLY OPEN POSITION
- ⑦ **LATCH:** ZINC PLATED ROTARY LATCH ASSEMBLY DESIGNED TO HOLD COVERS CLOSED AGAINST 90 PSF WIND UPLIFT  
ZINC PLATED STEEL LATCH STRIKERS ON COVERS

- ⑧ **HINGE:** CONTINUOUS
  - ⑨ **GASKET:** ADHESIVE BACKED EPDM RUBBER EXTRUSION
  - ⑩ **THERMAL RELEASE MECHANISM:** VENT COVERS OPEN THERMALLY BY HEAT AT FUSIBLE LINK TEMPERATURE 165°F
  - ⑪ **MANUAL OPERATION:** VENT COVERS OPEN WITH INTERNAL AND EXTERNAL MANUAL PULL HANDLES, 1/16" DIA SST CABLE, CLOSE VENT AT ROOFTOP
- SMOKE VENT SIZE 48"(WIDTH) x 96"(LENGTH)**

**PATENT PENDING**

PROJECT:				
ARCHITECT:				
CONTRACTOR:				
QTY:				
PART#:		<b>BSVEA48X96D6N165R-LPW</b>		
 9300 73rd Avenue North Brooklyn Park, MN 55428		TITLE:		
		Smoke Vent, Dome, 48x96, Dbl Dr, Alum, Mill, Apron Mount,		
NAME	DATE	SIZE	DWG. NO.	REV
DRAWN	SGS	05/26/16	A	Babcock SV BSVEA48X96D6N165R-LPW ShpDr
RELEASED	IMT	08/01/16	WEIGHT: 110 LBS	SHEET 1 OF 2

PROPRIETARY AND CONFIDENTIAL: THE INFORMATION CONTAINED IN THIS DRAWING IS THE SOLE PROPERTY OF BABCOCK-DAVIS. ANY REPRODUCTION IN PART OR AS A WHOLE WITHOUT THE WRITTEN PERMISSION OF BABCOCK-DAVIS IS PROHIBITED.

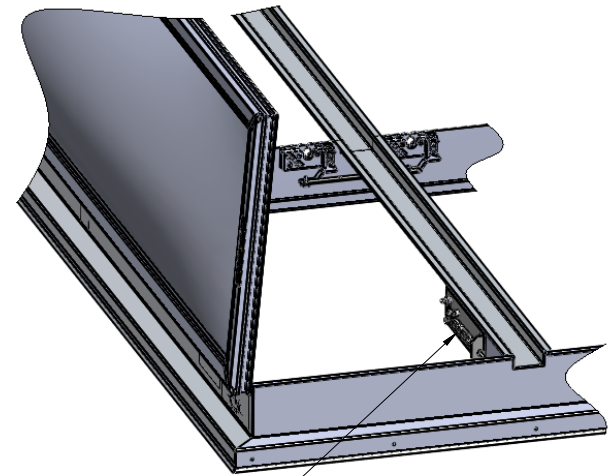
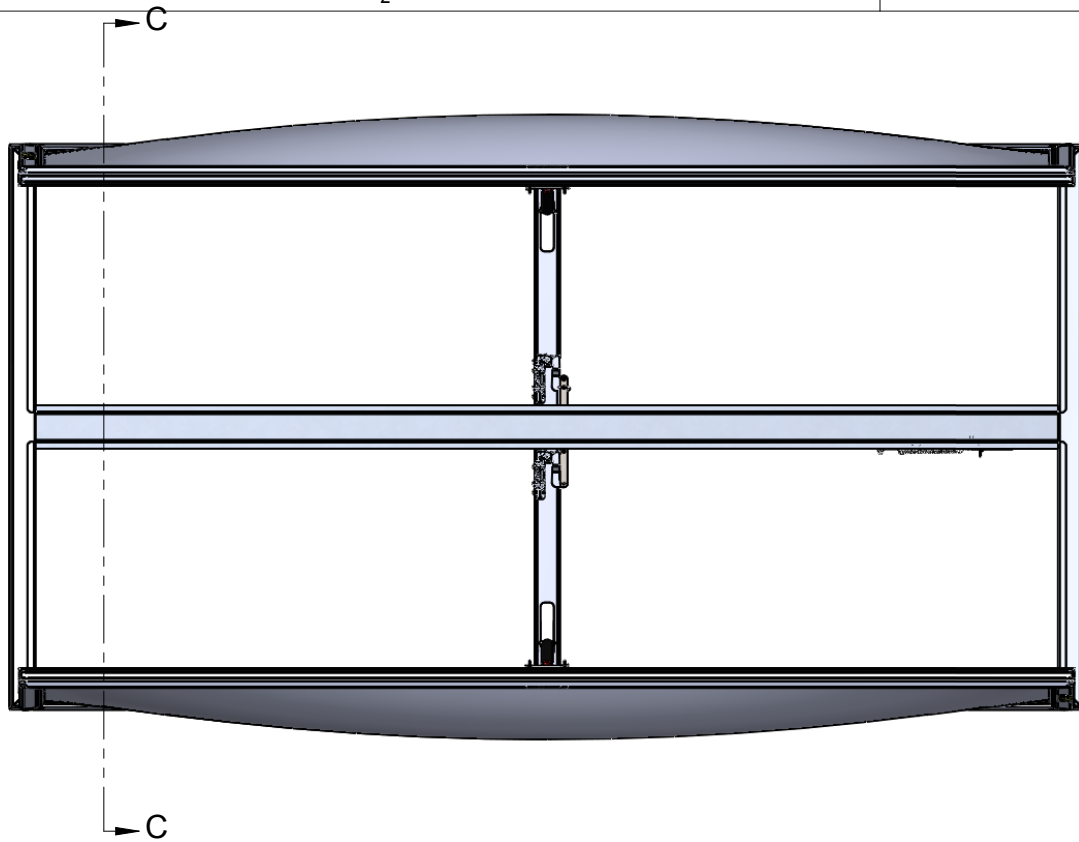

ALM

**SECTION C-C**

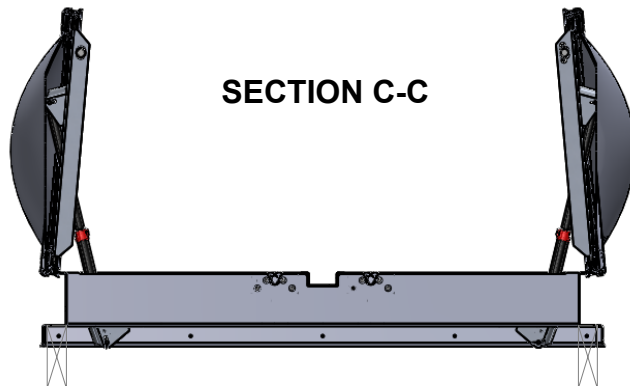

CONCRETE/WOOD/OTHER  
MATERIAL PROVIDED BY OTHER  
NIC

**babcockdavis**  
 9300 73rd Avenue North  
 Brooklyn Park, MN 55428

TITLE: Smoke Vent, Dome,  
 48x96, Dbl Dr,  
 Alum, Mill, Apron Mount,

	NAME	DATE	SIZE	DWG. NO.	REV
DRAWN	SGS	05/26/16	Babcock	SV BSVEA48X96D6N165R-LPW ShpDr	
RELEASED	IMT	08/01/16	WEIGHT: 110 LBS		SHEET 2 OF 2