

SPECIFICATIONS:

① DOOR:
ALUMINUM 1/4" DIAMOND PLATE, MILL FINISH WITH A LIVE LOAD OF 250PSF WITH A MAX SPAN DEFLECTION OF L/150

② FRAME:
ALUMINUM, 1/4" EXTRUSION, GRAY PRIMER FINISH ON EXTERIOR SURFACES THAT COME INTO CONTACT WITH CONCRETE

③ HINGES: TYPE 316 STAINLESS STEEL

④ SLAM LATCH:
ZINC-PLATED STEEL WITH INSIDE HANDLE MECHANISM AND OUTSIDE REMOVABLE HANDLE

⑤ COUNTER-BALANCE SPRING:
ENCLOSED, TYPE 17-7 SST SPRING

⑥ HOLD-OPEN ARM: TYPE 316 STAINLESS STEEL

OPTIONAL SELF-CLOSING MECHANISM

⑦ ANCHOR: BOLT-ON ANCHOR STRAPS PROVIDED

⑧ PLUG SEAL: TYPE 316 STAINLESS STEEL

CERTIFICATION: 2-HOUR FIRE RATED, WARNOCK HERSEY LABELED AND TESTED TO NFPA 288: STD METHODS OF FIRE TEST OF HORIZONTAL FIRE DOOR ASSEMBLIES. MAX TEMPERATURE RISE OF 250F.

APPLICATION NOTE: FLOOR DOOR MUST BE KEPT DRY BEFORE, DURING, AND AFTER INSTALLATION. FOR DRY, INTERIOR INSTALLATION ONLY. NOT INTENDED FOR EXTERIOR OR HUMID ENVIRONMENTS. UNITS LARGER THAN 36" X 36" MAY REQUIRE TWO PEOPLE TO OPERATE SAFELY.

FLOOR DOOR SIZE:

PROJECT:			
ARCHITECT:			
CONTRACTOR:			
QTY:			
PART#:			
		TITLE: FD, 2hr Fire Rated, 250 psf, Sngl Dr, Alum, 1/4" Dmd Plt, Mill, Angle Frame, Gray Primer, Cast-In, SST Spring Asst, 316 SST HDW, Slam Latch w/Hdl	
9300 73rd Avenue North Brooklyn Park, MN 55428			
NAME	DATE	SIZE	DWG. NO.
DRAWN	BES	A	Babcock FD BFDFPA_X_SWL ShpDr
RELEASED	BES	WEIGHT:	SHEET 1 OF 2

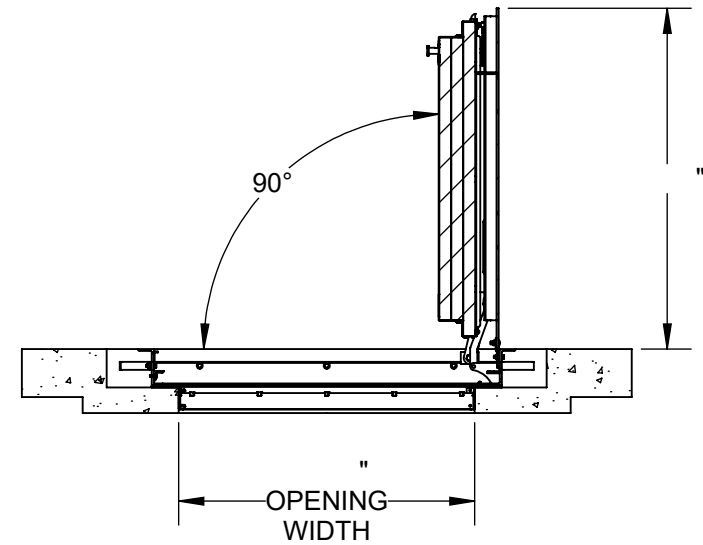
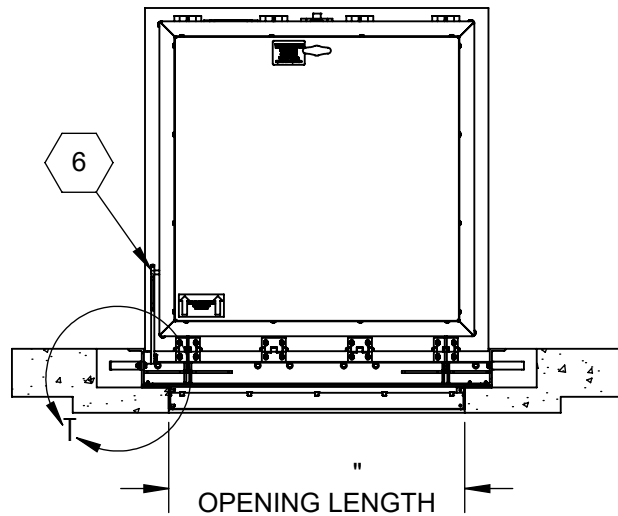
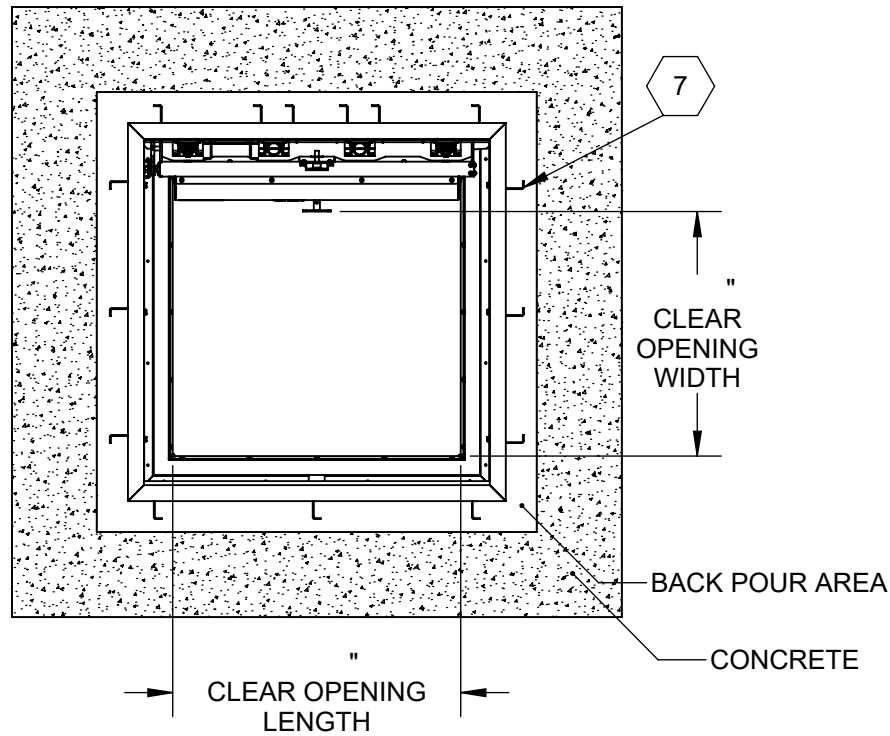

8"
MIN. DEPTH
REQUIRED TO
RETAIN FIRE
RATING

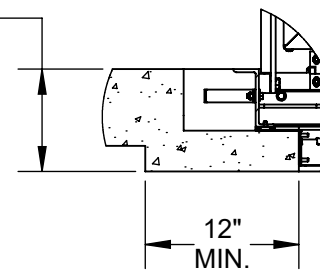

CAST-IN DETAIL

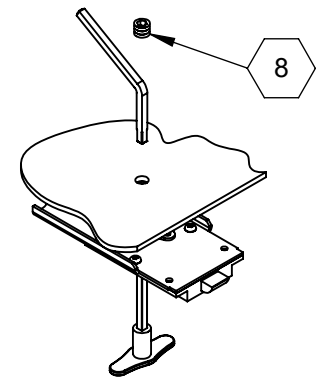

SLAM LATCH DETAIL

babcockdavis
9300 73rd Avenue North
Brooklyn Park, MN 55428

TITLE: FD, 2hr Fire Rated, 250 psf,
, Sngl Dr, Alum, 1/4" Dmd Plt,
Mill, Angle Frame, Gray Primer, Cast-In,
SST Spring Asst, 316 SST HDW, Slam Latch w/Hdl

	NAME	DATE	SIZE	DWG. NO.	REV
DRAWN	BES		A	Babcock FD BFDFA_X_SWL ShpDr	
RELEASED	BES		WEIGHT:		SHEET 2 OF 2