

SECTION B-B

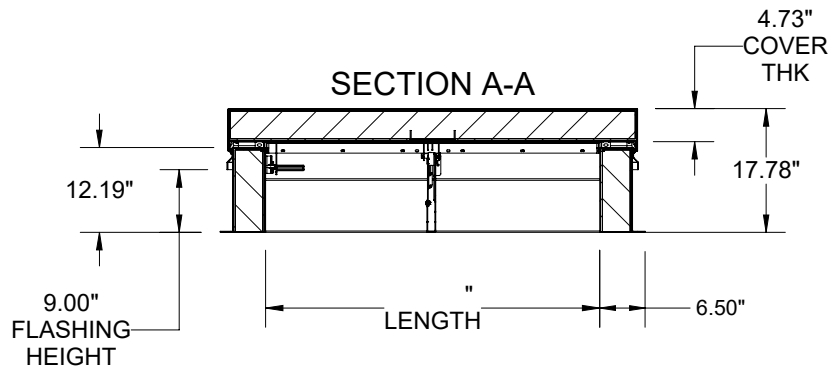

SPECIFICATIONS:

- ① **COVER:** 14 GAUGE GALVANNEAL COVER STIFFENED TO WITHSTAND A LIVE LOAD OF 40 PSF WITH A MAX DEFLECTION OF 1/150 OF THE SPAN
- ② **LINER:** 12 GAUGE GALVANNEAL
- ③ **CURB:** DBL WALL CURB, 12 GAUGE GALVANNEAL
- ④ **FINISH:** COVER - POWDER COAT, HIGH REFLECTANCE WHITE EXTERIOR, BLACK INTERIOR
CURB - POWDER COAT, BLACK
- ⑤ **GAS SPRING WITH DAMPER:** DESIGNED TO OPEN AGAINST A 10PSF SNOW LOAD IN NOT LESS THAN 2 SECONDS
- ⑥ **HOLD OPEN ARM:** LOCKS COVER IN FULLY OPEN POSITION - ZINC PLATED STEEL
- ⑦ **LATCH:** ZINC PLATED STEEL ROTARY LATCH ASSEMBLY DESIGNED TO HOLD COVERS CLOSED AGAINST 90 PSF WIND UPLIFT, ZINC PLATED STEEL LATCH STRIKERS ON COVERS

- ⑧ **HINGES:** 304 STAINLESS STEEL BUTT HINGE WITH 1/4" PIN
- ⑨ **INSULATION:** MINERAL WOOL W/ SOUND MAT, R-VALUE 16.8
- ⑩ **GASKETS:** ADHESIVE BACKED EPDM RUBBER EXTRUSION ON CURB AND COVER
- ⑪ **THERMAL RELEASE MECHANISM:** VENT COVERS OPEN THERMALLY BY HEAT AT FUSIBLE LINK TEMPERATURE
- ⑫ **MANUAL OPERATION:** VENT COVERS OPEN WITH INTERNAL AND EXTERNAL MANUAL PULL HANDLES, 1/16" DIA SST CABLE, CLOSE VENT AT ROOFTOP
- ⑬ **ELECTRICAL RELEASE/CONTROL:** NONE
- ⑭ **SOUND RATING:** STC50 PER ASTM E90, OITC 47 PER ASTM E1332

SMOKE VENT SIZE: "(WIDTH) x "(LENGTH)

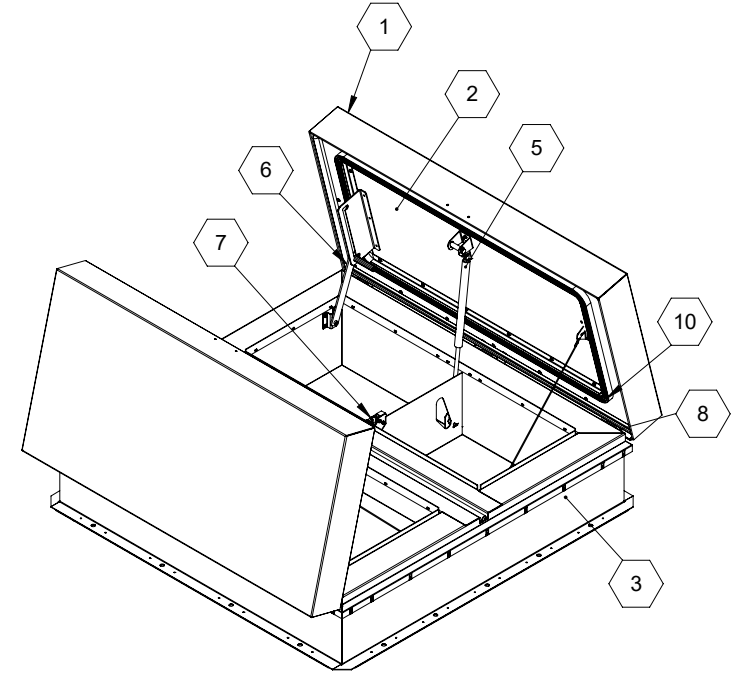

PROJECT:

ARCHITECT:

CONTRACTOR:

QTY:

PART#:

babcockdavis®

9300 73rd Avenue North

Brooklyn Park, MN 55428

TITLE: Smoke Vent, Acoustical STC50,

Galvn Steel, Black Pwd, Wht Pwd Cvr Ext, Dbl Wall Curb,

	NAME	DATE	SIZE	DWG. NO.	REV
DRAWN			A	Babcock SV BSVZG_X_D2N_R ShpDr	-
RELEASED			WEIGHT: VARIES		SHEET 1 OF 2

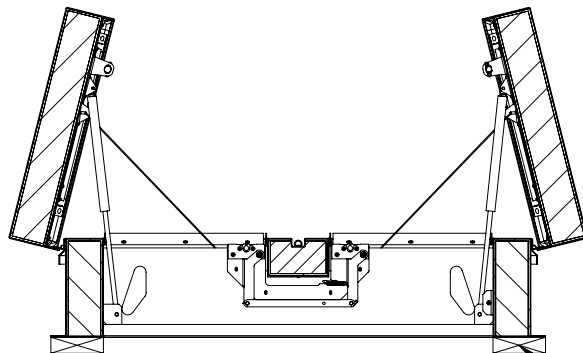
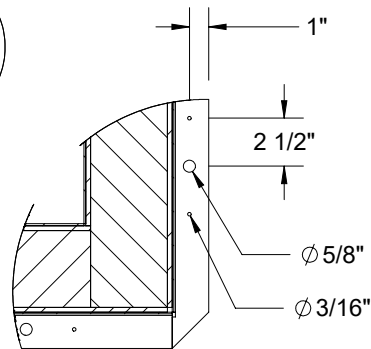
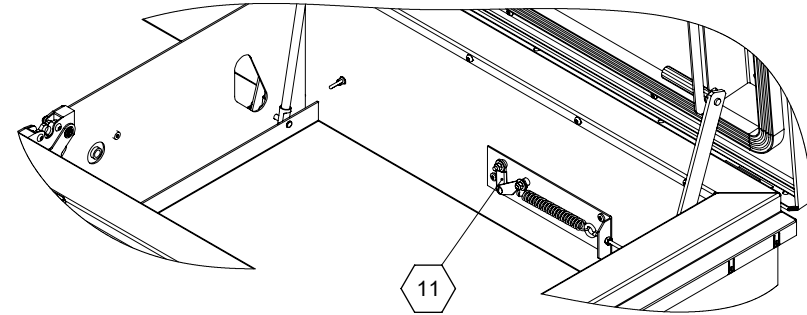
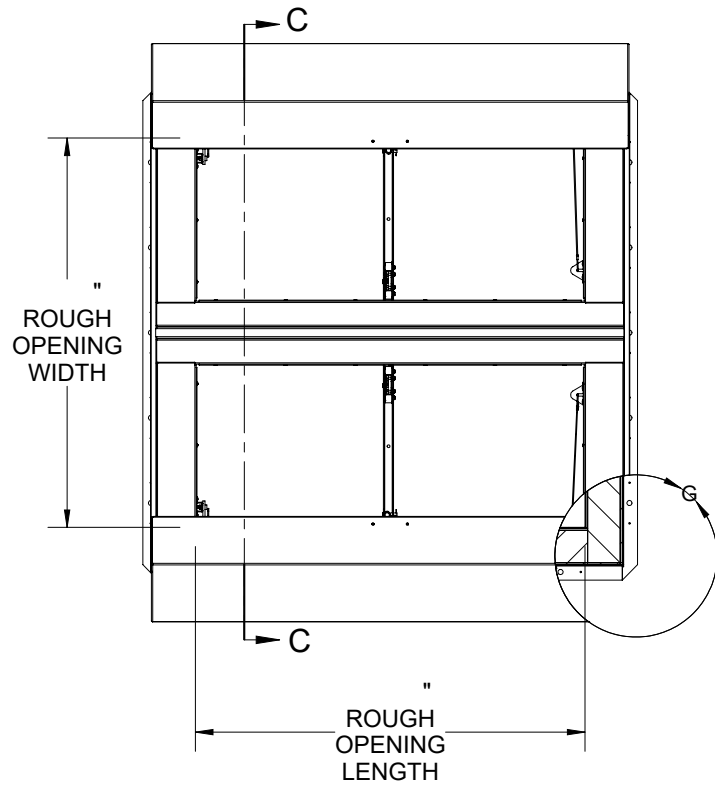

SECTION C-C

WOOD, CONCRETE, OTHER
MATERIAL FOR MOUNTING
BY OTHERS (NIC)



9300 73rd Avenue North
Brooklyn Park, MN 55428

TITLE: Smoke Vent, Acoustical STC50,

Galvn Steel, Black Pwd, Wht Pwd Cvr Ext, Dbl
Wall Curb,

	NAME	DATE	SIZE	DWG. NO.	REV
DRAWN			A	Babcock SV BSVZG_X_D2N_R ShpDr	-
RELEASED				WEIGHT: VARIES	SHEET 2 OF 2