

SPECIFICATIONS:

- ① **COVER:** 11 GA (0.090") ALUM COVER STIFFENED TO WITHSTAND A LIVE LOAD OF 40PSF WITH A MAX DEFLECTION OF 1/150 OF THE SPAN
- ② **LINER:** 18 GA (0.04") ALUM
- ③ **CURB:** 11 GA (0.09") ALUM, CURB COUNTERFLASH WITH EZ TABS
- ④ **FINISH:** MILL
- ⑤ **HINGE:** PINTLE HINGE WITH STAINLESS STEEL HINGE PINS
- ⑥ **SPRING:** GAS SPRING WITH DAMPER FOR SMOOTH, CONTROLLED COUNTERBALANCED LIFT ASSIST
- ⑦ **HOLD OPEN ARM:** STEEL AUTOMATIC HOLD OPEN ARM LOCKS COVER IN FULLY OPENED POSITION WITH RED GRIP HANDLE RELEASE

- ⑧ **LATCH:** SINGLE POINT LATCH HOLDS COVER CLOSED AGAINST 20 PSF WIND UPLIFT. EXTERNAL PALM RELEASE, INTERNAL RELEASE HANDLE WITH PADLOCK HASP
- ⑨ **INSULATION:** 1" FIBERGLASS IN COVER, 1" POLYISO (R6) IN CURB
- ⑩ **GASKET:** ADHESIVE-BACKED EPDM RUBBER EXTRUSION
- ⑪ **PULL HANDLE:** INTERIOR PULL DOWN HANDLE
- ⑫ **DOMES:**

ROOF HATCH SIZE: " (WIDTH) x " (LENGTH)

OPTIONS

Stainless Steel Hardware

Double Wall Curb

PROJECT:			
ARCHITECT:			
CONTRACTOR:			
QTY:			
PART#:			
babcockdavis		TITLE:	
9300 73rd Avenue North Brooklyn Park, MN 55428			
NAME	DATE	SIZE	DWG. NO.
DRAWN		A	Generic Babcock RH BRHLA_X_S_P ShpDr
RELEASED		WEIGHT:	REV -

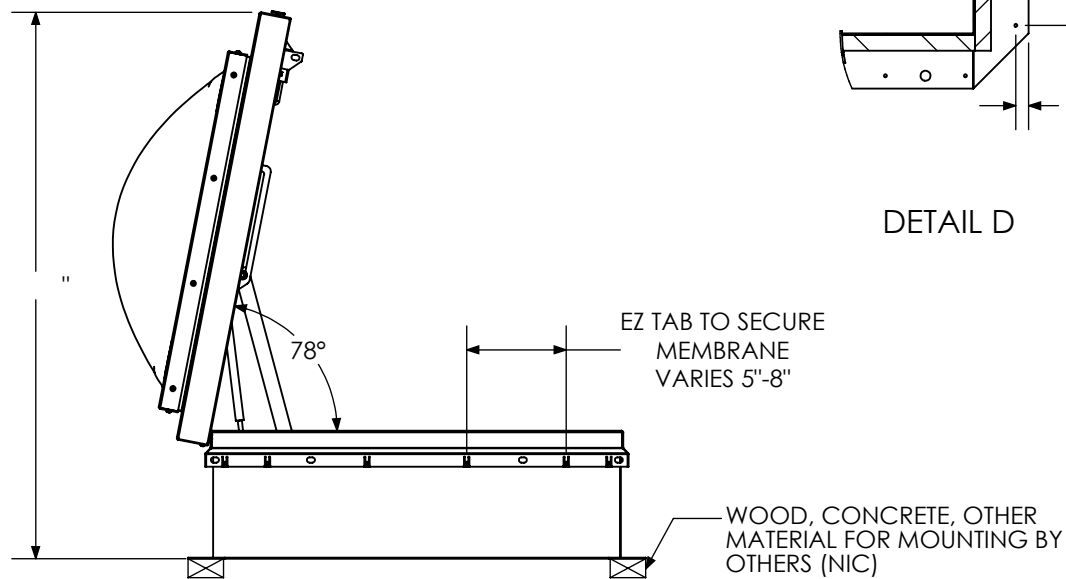
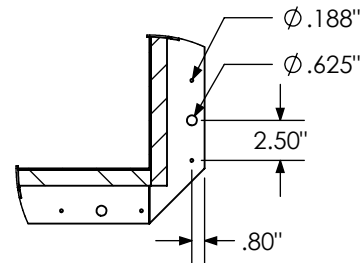
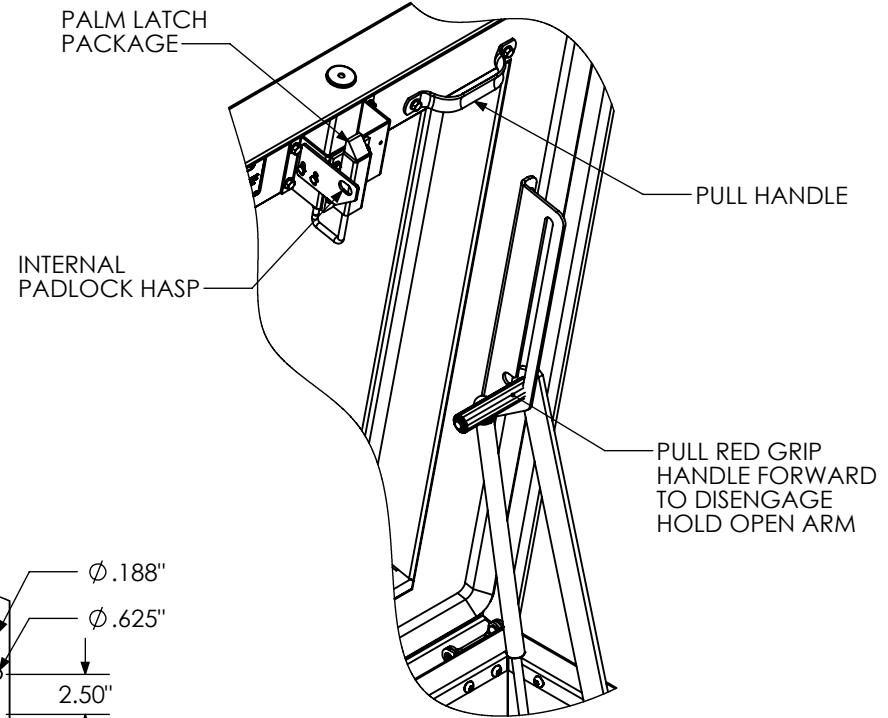
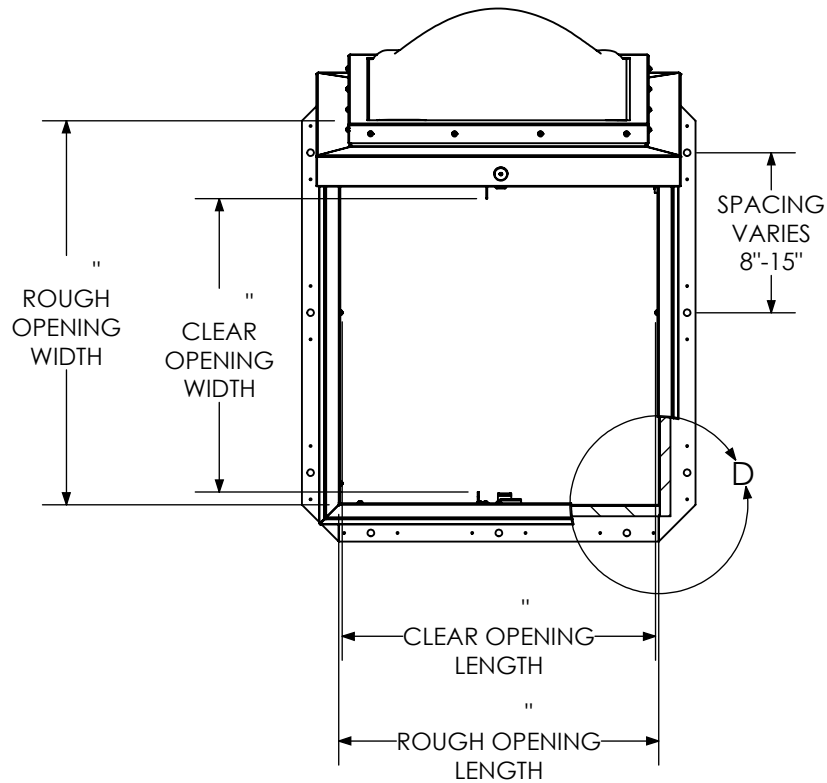

PROPRIETARY AND CONFIDENTIAL: THE INFORMATION CONTAINED IN THIS DRAWING IS THE SOLE PROPERTY OF BABCOCK-DAVIS. ANY REPRODUCTION IN PART OR AS A WHOLE WITHOUT THE WRITTEN PERMISSION OF BABCOCK-DAVIS IS PROHIBITED. ©2020 BABCOCK-DAVIS

babcockdavis			TITLE:		
9300 73rd Avenue North Brooklyn Park, MN 55428					
NAME	DATE	SIZE	DWG. NO.	REV	
DRAWN		A	Generic Babcock RH BRHLA_X_S_P ShpDr	-	
RELEASED		WEIGHT:	SHEET 2 OF 2		