

BGV12C

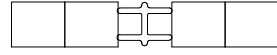

BGV12CC

QTY	MODEL	WIDTH	LENGTH	FINISH	LOCATION

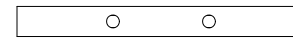
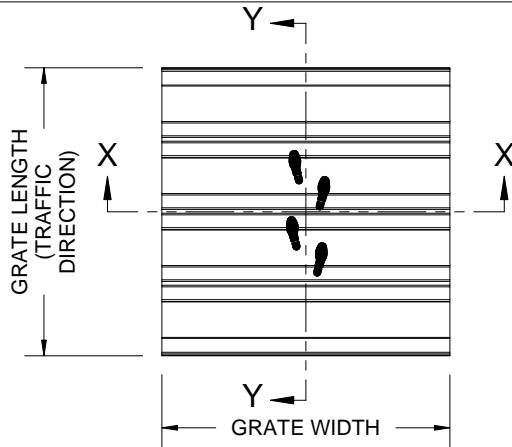

SECTION X-X

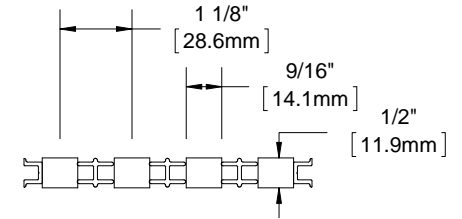

SECTION Y-Y

SINGLE TREAD

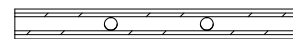
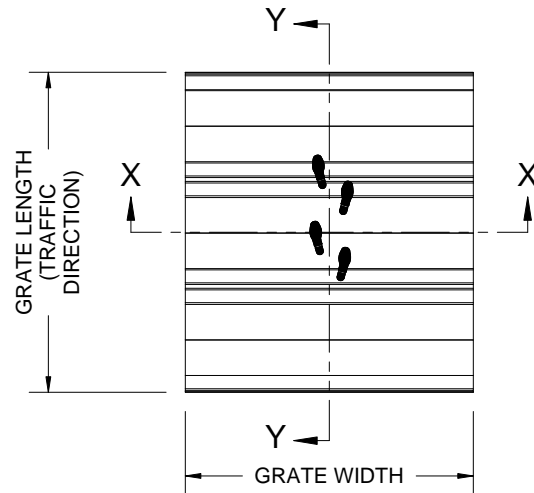

SECTION X-X

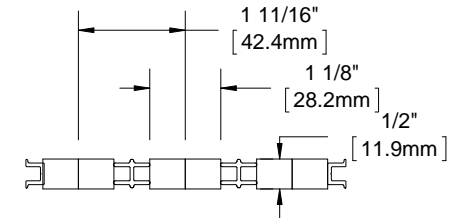

SECTION Y-Y

DOUBLE TREAD

- NOTES:**
- VERIFY TRAFFIC DIRECTION
 - ALL RAIL COMPONENTS ARE MADE OF 6063-T6 ALUMINUM ALLOY
 - TREAD RAILS MUST RUN PERPENDICULAR TO TRAFFIC DIRECTION
 - ADDITIONAL INFORMATION CAN BE FOUND IN THE PRODUCT SPECIFICATION AND IS CONSIDERED PART OF THIS TRANSMITTAL.

PROJECT:					
ARCHITECT:					
CONTRACTOR:					
<p>9300 73rd Avenue North Brooklyn Park, MN 55428</p>			DESCRIPTION:		
			envIRONtread II®, 15/32", Reversible Recycled Rubber Grate		
	NAME	DATE	SIZE	DWG. NO.	
DRAWN	DKL	4/17/15	A	BGV12C-NF	
RELEASED	PE	4/17/15	SCALE: NTS	SHEET 1 OF 1	REV B

PROPRIETARY AND CONFIDENTIAL: THE INFORMATION CONTAINED IN THIS DRAWING IS THE SOLE PROPERTY OF BABCOCK-DAVIS. ANY REPRODUCTION IN PART OR AS A WHOLE WITHOUT THE WRITTEN PERMISSION OF BABCOCK-DAVIS IS PROHIBITED.