

Weighted Base

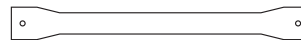

Fixed Rail

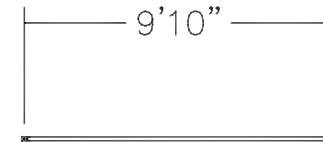
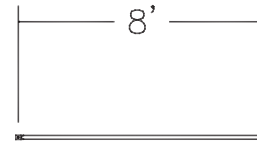
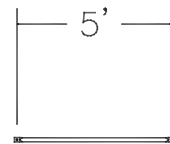
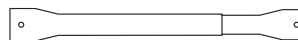
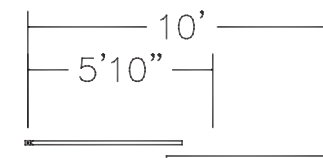
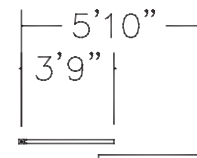
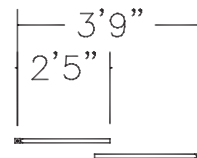

Adjustable Rail

Model	Description	Dimension
BGR-WBP-ASM-RN	Weighted Base and Post	26.875" x 46"
BGR-WBPR-005-RN	One 5' Rail	5'
BGR-WBPR-008-RN	One 8' Rail	8'
BGR-WBPR-010-RN	One 10' Rail	9'-10"
BGR-WBPR-ADJ-043-RN	Adjustable Rail, 29"-43"	2'-5" to 3'-9"
BGR-WBPR-ADJ-070-RN	Adjustable Rail, 43"-70"	3'-9" to 5'-10"
BGR-WBPR-ADJ-120-RN	Adjustable Rail, 70"-120"	5'-10" to 10'
BGR-WB-AC	Adj Corner Bracket	

SPECIFICATIONS:

1. MATERIAL:

- POST: STEEL, 1.25" ID (1.66") X .140" SCHEDULE 40 PIPE (ASTM A53)
- HORIZONTAL FIXED RAIL: 1.625" X .065" (ASTM C1008/1010) STEEL TUBE RAILS
- HORIZONTAL ADJUSTIBLE RAIL: 1.625" X .065" AND 1.375" X .065" (ASTM C1008/1010) STEEL TUBE ADJUSTIBLE SLIDE RAILS

2. FINISH: POWDER COAT

3. HARDWARE: 3/8"-16 X 1" ZINC PLATED STEEL RAIL FASTENERS

4. STANDARDS: MEETS AND EXCEEDS OSHA STANDARD 1910.23 and 1926.502

PROPRIETARY AND CONFIDENTIAL: THE INFORMATION CONTAINED IN THIS DRAWING IS THE SOLE PROPERTY OF BABCOCK-DAVIS. ANY REPRODUCTION IN PART OR AS A WHOLE WITHOUT THE WRITTEN PERMISSION OF BABCOCK-DAVIS IS PROHIBITED.

			TITLE: GUARDRAIL, WEIGHTED BASE		
9300 73rd Avenue North Brooklyn Park, MN 55428					
NAME	DATE	SIZE	DWG. NO.	REV	
DRAWN MD	06/16/16	A	BFP-GRP8	A	
RELEASED MD	06/16/16	WEIGHT:	SHEET 1 OF 1		