

SPECIFICATIONS:

- ① **DOOR:** ALUMINUM, 1/4" DIAMOND PLATE, MILL FINISH WITH A LIVE LOAD OF 300 PSF 5 B 8 MAX SPAN DEFLECTION OF @150
- ② **FRAME:** ALUMINUM, 1/4" EXTRUSION, GRAY PRIMER FINISH ON EXTERIOR SURFACES THAT COME IN CONTACT WITH CONCRETE
- ③ **HINGES:** TYPE 316 STAINLESS STEEL
- ④ **SLAM LATCH:** TYPE 316 STAINLESS STEEL WITH INSIDE LEVER HANDLE AND OUTSIDE REMOVABLE 5/16" SQUARE L HANDLE
- ⑤ **COUNTER-BALANCE SPRING:** ENCLOSED 17-7 STAINLESS STEEL SPRING
- ⑥ **HOLD-OPEN ARM:** TYPE 316 STAINLESS STEEL WITH RED VINYL GRIP HANDLE
- ⑨ **DRAINAGE COUPLING:** 1-1/2"
- ⑩ **FLUSH TYPE PLUG SEAL:** TYPE 316 STAINLESS STEEL
- ⑪ **GASKET:** EPDM AIR TIGHT GASKET

PROPRIETARY AND CONFIDENTIAL: THE INFORMATION CONTAINED IN THIS DRAWING IS THE SOLE PROPERTY OF BABCOCK-DAVIS. ANY REPRODUCTION IN PART OR AS A WHOLE WITHOUT THE WRITTEN PERMISSION OF BABCOCK-DAVIS IS PROHIBITED. THIS SHOP DRAWING MAY NOT BE AN ACTUAL REPRESENTATION OF THE FINAL PRODUCT.

PROJECT:															
ARCHITECT:															
CONTRACTOR:															
QTY:															
PART#:															
 9300 73rd Avenue North Brooklyn Park, MN 55428		TITLE: Floor Door, Drainable Series, Sngl Dr, 316 SST Hdw, Alum, Mill, Pedestrian, Cast-In, Slam Latch Removbl L Hdl													
		<table border="1"> <thead> <tr> <th>NAME</th> <th>DATE</th> <th>SIZE</th> <th>DWG. NO.</th> <th>REV</th> </tr> </thead> <tbody> <tr> <td>DRAWN</td> <td>JPB</td> <td>2-6-18</td> <td>A</td> <td>Babcock FD BFDDPA_X_SFL ShpDr</td> </tr> <tr> <td>RELEASED</td> <td>TR</td> <td>2-6-18</td> <td>WEIGHT: NA</td> <td>SHEET 1 OF 2</td> </tr> </tbody> </table>	NAME	DATE	SIZE	DWG. NO.	REV	DRAWN	JPB	2-6-18	A	Babcock FD BFDDPA_X_SFL ShpDr	RELEASED	TR	2-6-18
NAME	DATE	SIZE	DWG. NO.	REV											
DRAWN	JPB	2-6-18	A	Babcock FD BFDDPA_X_SFL ShpDr											
RELEASED	TR	2-6-18	WEIGHT: NA	SHEET 1 OF 2											

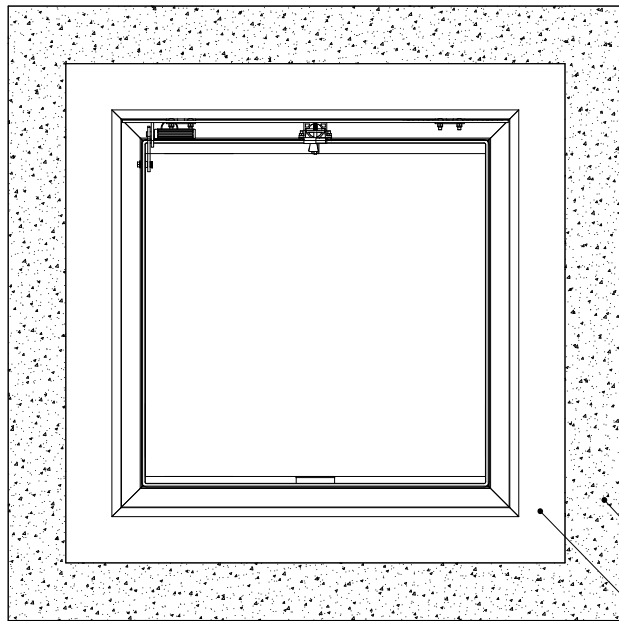

CONCRETE

BACK POUR AREA

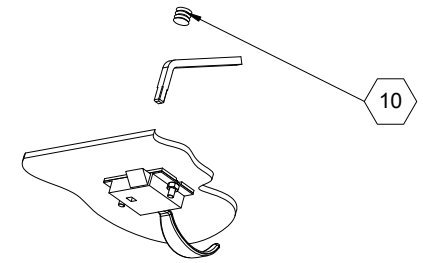
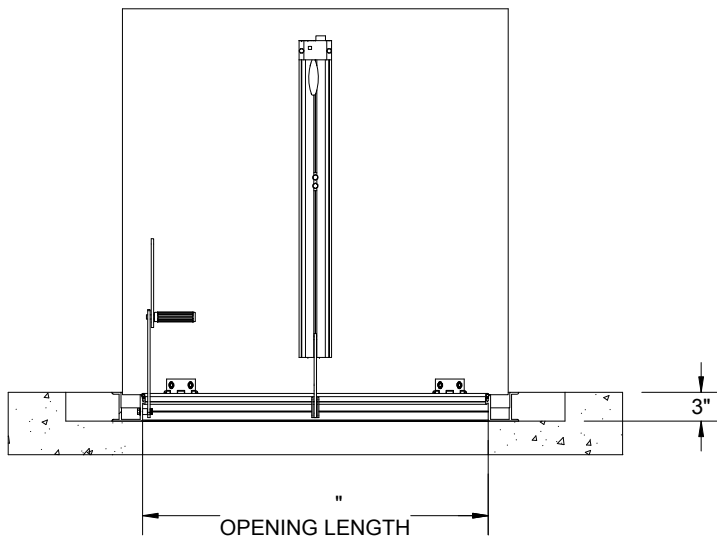
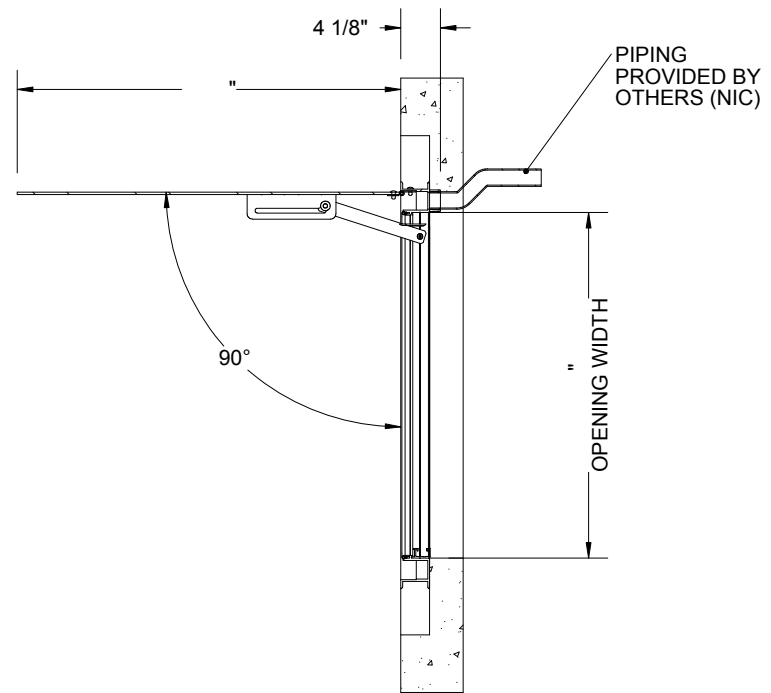

SLAM LATCH DETAIL

				TITLE: Floor Door, Drainable Series, Sngl Dr, 316 SST Hdw, Alum, Mill, Pedestrian, Cast-In, Slam Latch Removbl L Hdl	
9300 73rd Avenue North Brooklyn Park, MN 55428				DWG. NO. Babcock FD BFDDPA_X_SFL ShpDr	
DRAWN	JPB	2-6-18	SIZE	A	REV
RELEASED	TR	2-6-18	WEIGHT:	NA	SHEET 2 OF 2

PROPRIETARY AND CONFIDENTIAL: THE INFORMATION CONTAINED IN THIS DRAWING IS THE SOLE PROPERTY OF BABCOCK-DAVIS. ANY REPRODUCTION IN PART OR AS A WHOLE WITHOUT THE WRITTEN PERMISSION OF BABCOCK-DAVIS IS PROHIBITED. THIS SHOP DRAWING MAY NOT BE AN ACTUAL REPRESENTATION OF THE FINAL PRODUCT.