

QUANTITY	HEIGHT

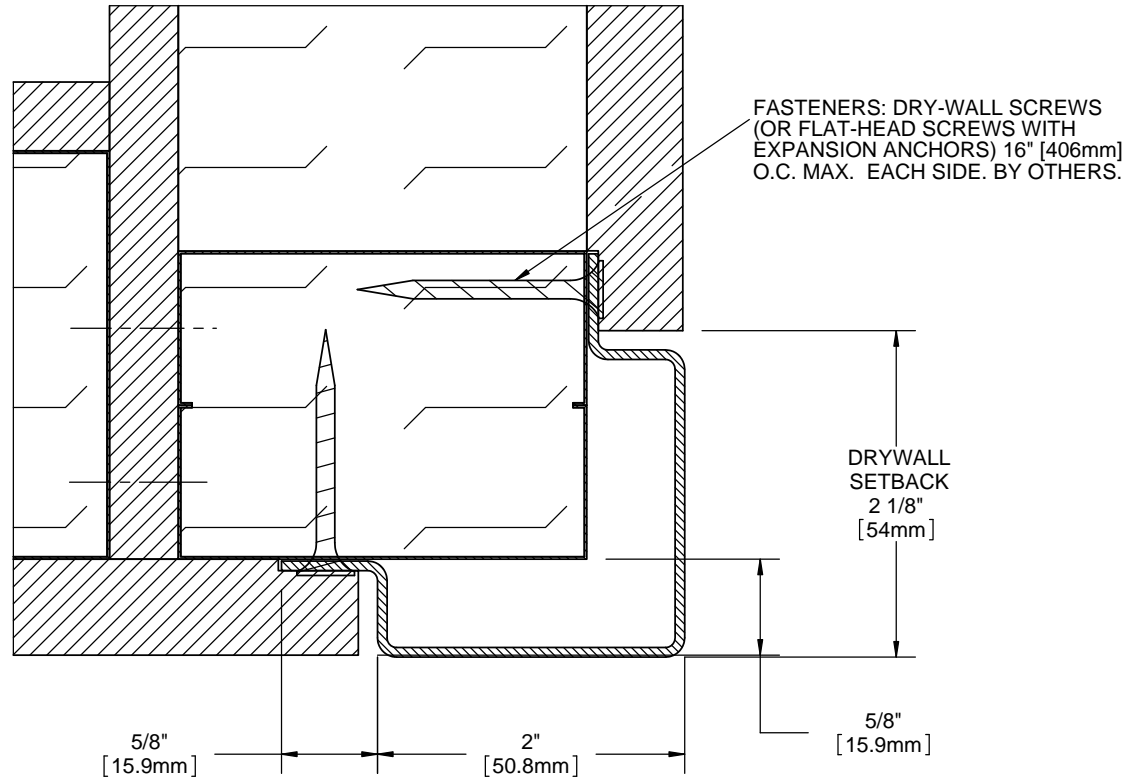

**NOTES:**

- MECHANICALLY FASTENED APPLICATION
- MATERIAL: TYPE 304 STAINLESS STEEL, 16 GAUGE WITH ROUNDED EDGES.
- FINISH: SATIN #4 WITH REMOVABLE PROTECTIVE COATING.
- AVAILABLE IN 90° (STANDARD), CUSTOM ANGLES AVAILABLE.
- CONTINUOUS LENGTHS AVAILABLE 10' MAXIMUM.
- EMBOSSED PATTERNS AVAILABLE IN 304 STAINLESS STEEL ONLY. GAUGE AND LENGTH MAY VARY DEPENDING ON PATTERN.
- FASTENERS AND PARTITION COMPONENTS BY OTHERS.

PROJECT:					
ARCHITECT:					
CONTRACTOR:					
 9300 73rd Avenue North Brooklyn Park, MN 55428		TITLE:			
		CORNER GUARD, STAINLESS STEEL, TYPE 304, 2" X 2" WINGS, DRILLED, RECESS MOUNT, 90 DEGREE, 16 GAUGE			
	NAME	DATE	SIZE	DWG. NO.	REV
DRAWN	DKL	9/30/12	A	BCGSR2SD	A
RELEASED	PGE	10/22/12		WEIGHT: 2.0 LB/LF	SHEET 1 OF 1