

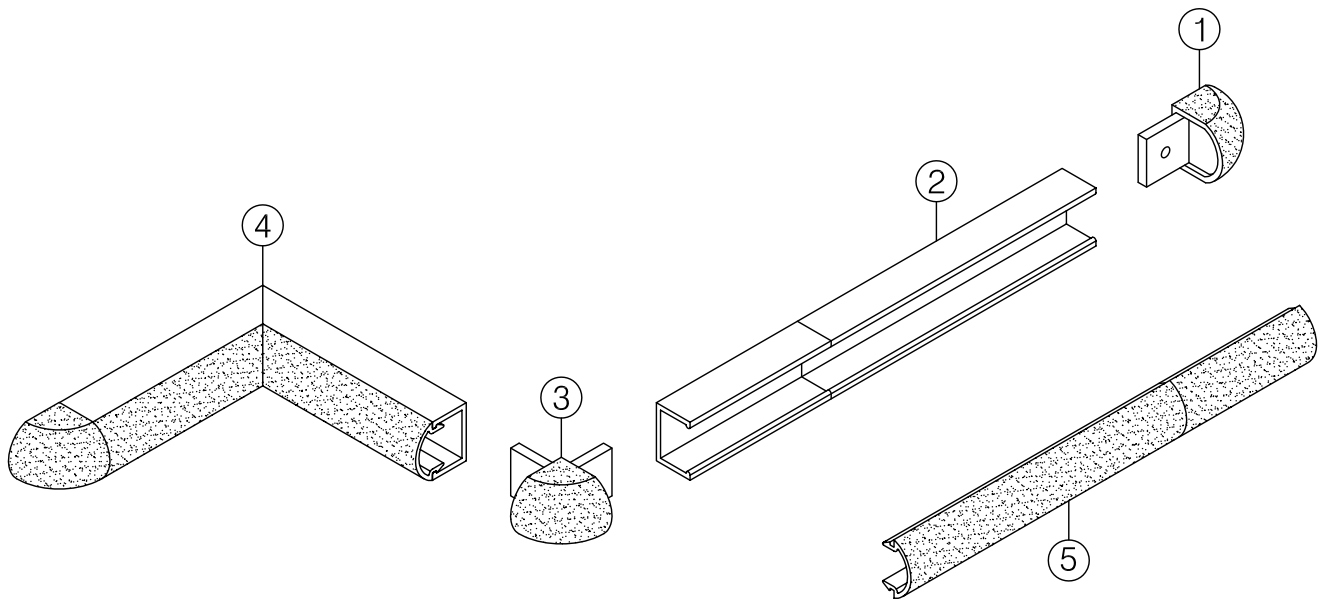

## 2 inch Bumper Guard

Model(s): BBGVS15C-P



## Table of Contents

General Description.....3  
 Installation.....4-7  
 Parts List.....8  
 Maintenance.....9  
 Standard Warranty.....10  
 Factory Assistance.....11

### Copyright

2017 by Babcock-Davis All rights reserved.

This document contains proprietary information. No part of this document may be reproduced without the prior written consent of Babcock-Davis.

### Note

The information in this document is subject to change without notice.

### General Safety Precautions

Improper selection, installation, or use can cause personal injury or property damage. It is solely the responsibility of the user, through its own analysis to select products suitable for their specific application requirements, ensure they are properly maintained, and limit their use to its intended purpose.

Follow proper local, state and federal regulations for proper installation and operation requirements.

GENERAL DESCRIPTION

Vinyl bumper guards are designed for years of safe building use. Proper installation of the handrails are critical to the product's performance. The following are general instructions for installing, maintaining and cleaning vinyl bumper guards. These are recommended general guidelines only. Locally accepted installation practices and procedures should be followed to ensure a system that meets all local code requirements.

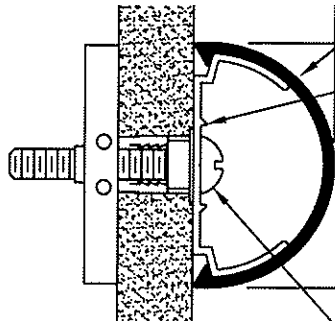

## INSTALLATION

Preparation: Verify that all products listed on the packaging slip are included in the package. Check the products for damage. If product is damaged, contact customer support immediately to report a freight claim.

Store material in a clean dry place where the temperature is maintained between 50°F (10°C) and 100°F (38°C). Walls and rooms should be maintained at a minimum of 65°F (18°C) for at least 48 hours prior to installation. Acclimate materials to normal building conditions for at least 24 hours before cutting and installing.

**Step 1** Determine top of bumper guard and snap a chalk line 1/8 inch below to locate top of retainer, see **fig. 1**.

**Step 2** Cut retainer. See **Cutting Adjustment Diagrams and Schedule** for adjustments to retainer length at end caps, inside corners, and outside corners. Refer to **Minimum Layout Configurations** for additional information. Retainer should be mitered to accommodate outside corners that are not 90° and all inside corners. All cuts must be square and deburred.

**Step 3** Pre-drill clearance holes in retainer along the v-groove provided in the retainer, see **fig. 2**. Use a #15 (.180 inch) bit for #8 fastener or a #7 (.01 inch) bit for #10 and 3/16 inch fasteners. Space holes at 16 inches on center. Adjust spacing to accommodate studs as necessary. Do not pre-drill at locations that will interfere with installation of molded accessories.

Drill point fasteners may be used without pre-drilling retainer on drywall installations having continuous metal backer or studs. Continue to pre-drill at locations where no backing or stud is available.

**Step 4** Pre-drill for attachment of molded accessories by inserting accessory in end of retainer. Press firmly to ensure molded part is seated squarely against retainer.

- Drywall Installation: Using the accessory as a template, pre-drill clearance holes for mounting through to metal backer or stud or pre-drill pilot holes using #29 (.136 inch) bit for #8 fastener or a #21 bit (.159 inch) for #10 fastener for attaching accessories directly to retainer, see **fig. 3**.
- Masonry Installation: Using the accessory as a template, pre-drill clearance holes at mounting locations, see **fig. 3**.

**Step 5** Fasten retainer and spacer to wall using hardware listed below. Align top edge of retainer with chalk line.

Important: Begin installation of retainer at corners allowing for molded accessories. Use the appropriate accessory as a spacing template. See **Cutting Adjustment Diagrams and Schedule** for additional information. Do not fasten through holes pre-drilled for installation of molded accessories until accessories are installed in **Step 6**.

INSTALLATION

- Drywall Installation: Fasten retainer to wall using hardware listed below. If it is necessary to install fasteners in locations where there is no metal backing or stud, use pre-drilled retainer as a template to mark and drill wall for Toggler brand toggle bolts or plastic Alligator insert in accordance with instructions provided with hardware.
- Masonry Installation: Using the pre-drilled retainer as a template, mark and drill the wall at all pre-drilled holes to accept plastic Alligator insert or 3/16 inch Tapcon or similar fastener. Drill in accordance with instructions provided with hardware.

**Suggested hardware**

• Drywall with metal backing	#8 or #10 drill point drywall screw, pan head or hex washer head sheet metal screw.
• Drywall without stud or backing	Plastic Alligator insert with #8 or #10 pan head or hex washer sheet metal screw or 3/16 inch Toggler brand toggle bolts with pan head machine screw.
• Masonry	Plastic Alligator insert with #8 or #10 pan head washer head sheet metal screw or 3/16 inch hex washer head Tapcon.

**Step 6** Secure accessory components in place using hardware selected in **Step 5**.

Caution: Use of a flat washer at accessory mounting tabs is recommended to prevent damage to molded part caused by excessive tightening of the fastener.

**Step 7** Measure between accessories and cut the vinyl cover accordingly. Miter cut the cover for all angles not accommodated by the molded accessories. Cut cover so that it will span retainer butt joints. All cuts must be square and deburred.

**Step 8** Snap the cover in place. Install cover to span butt joints in retainer.

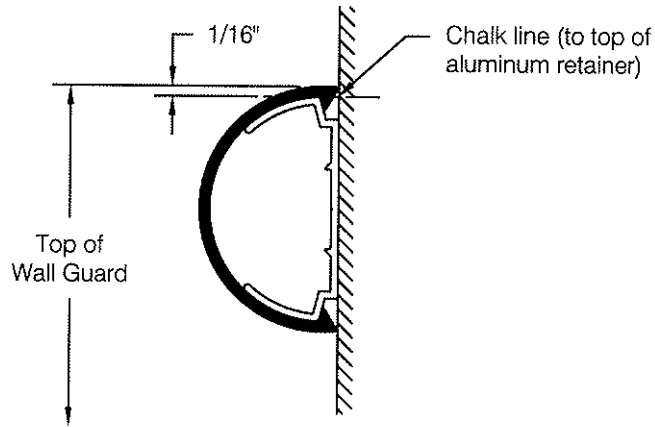

fig 1

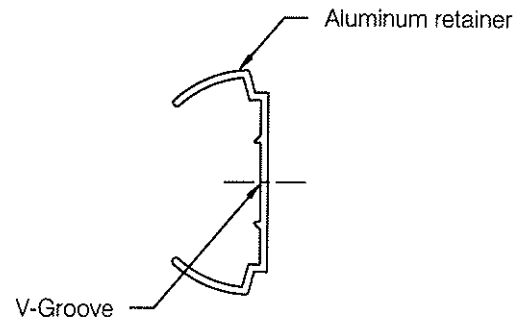

fig 2

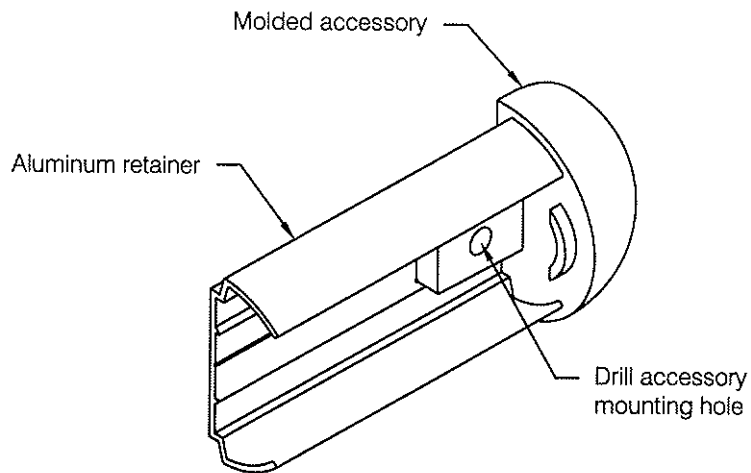
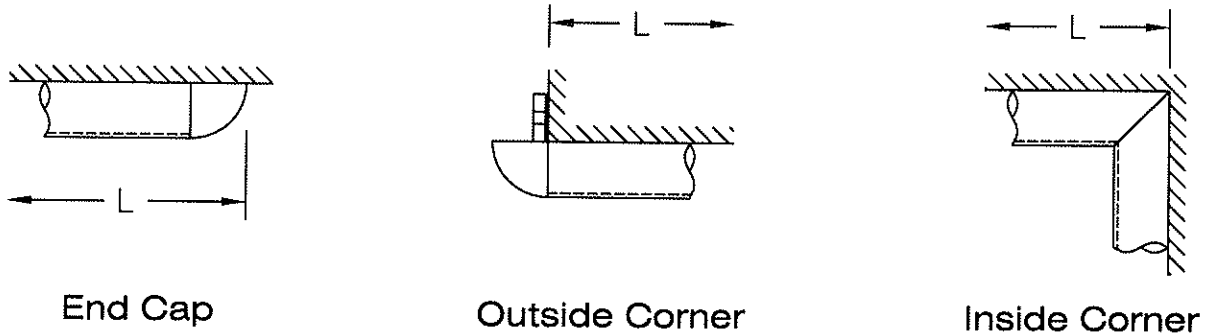

fig 3

CUTTING ADJUSTMENT DIAGRAMS AND SCHEDULE



	RETAINER	COVER
End Cap	L - 1-3/16"	L - 1-3/16"
Outside Corner	L - 0"	L - 0"
Inside Corner	L - 0" (field miter)	L - 0" (field miter)

Important: Install retainer and molded accessories before cutting the snap-on cover.

MINIMUM LAYOUT CONFIGURATIONS

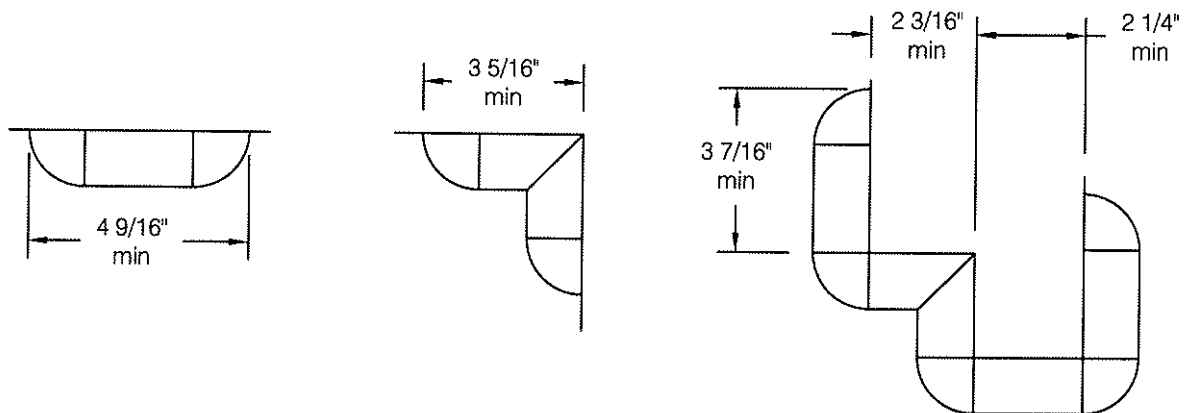

PARTS LIST

Diagram #	Part Number	Description
1	BBGVS2C-EC-P	LEFT/RIGHT END CAP
2	BBGVS2C-AR-P	ALUMINUM RETAINER
3	BBGVS2C-OC-P	OUTSIDE CORNER
4		FIELD MITERED CORNER
5	BBGVS2C-VC-P	SNAP ON COVER

When ordering, please specify color name. Current color charts are available on [www.BabcockDavis.com](http://www.BabcockDavis.com).

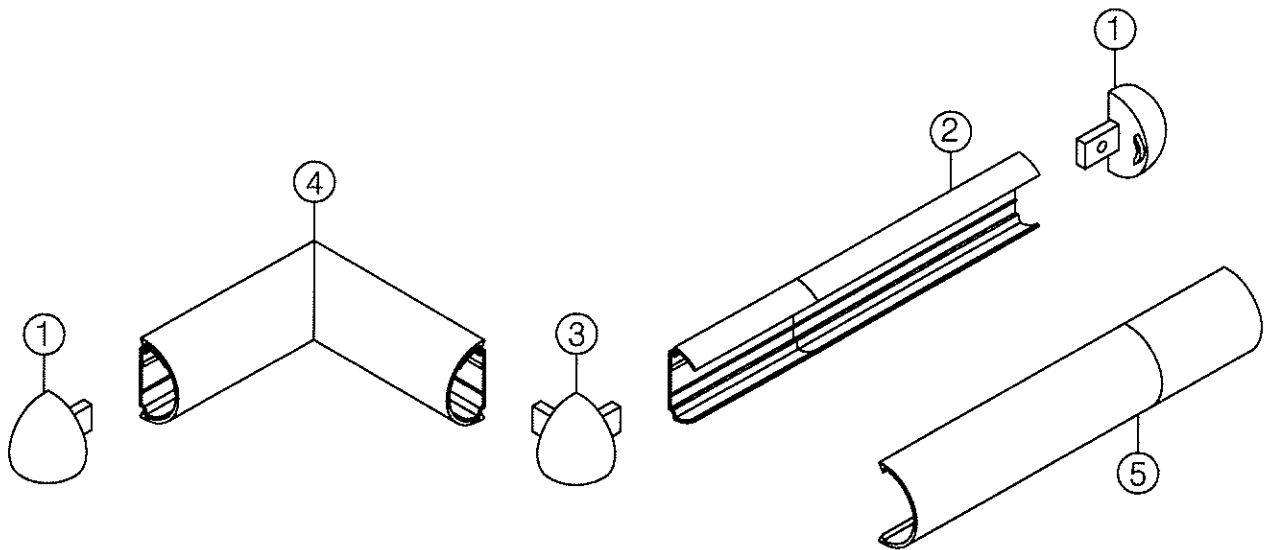



## MAINTENANCE

- Do not use ammonia based cleaner, powdered cleaners or bleach; they can leave a residue if not rinsed properly. Use a liquid cleaner, such as SoftScrub without bleach, Fantastic, 409, etc., on a sponge or a soft cloth; use a stiff bristle brush to remove heavy dirt from the textured surface if necessary. Always rinse with clean water and dry with a soft cloth.
- For heavy-duty cleaning (graffiti, etc.) use a stronger cleaning agent, such as “Crown Anti-Vandal Spray”, or the equivalent. Follow the same procedures noted above, always rinsing all areas thoroughly in clean water and drying completely.
- Do not use water with extremely high temperature and do not use steam to clean vinyl because it may cause blistering and/or warping.
- Do not use abrasive cleaners or other cleaning implements, such as steel wool or cleaning pads, as they may mark or gouge the material.
- To add luster and additional protection, you can apply a thin layer of a vinyl enhancer, such as Pledge.
- Please contact manufacturer for technical support questions and/or replacement parts such as repair kits.

STANDARD WARRANTY

Babcock-Davis warrants all Wall and Door Protection to be free from manufacturing defects in materials, factory finishes and workmanship for a period of five (5) years from the date of shipment. Should a product fail to function in normal use within this period, Babcock-Davis shall furnish a replacement or new part at Babcock-Davis' discretion. Failure to use product in methods consistent with Babcock-Davis product manuals shall relieve Babcock-Davis of any liability. Our liability under this warranty excludes installation or removal costs involved in the product replacement and excludes any responsibility for incidental or consequential damage of any nature.

For warranty support and registration please visit  
[www.BabcockDavis.com/support](http://www.BabcockDavis.com/support)

## FACTORY ASSISTANCE

Babcock-Davis engineers and manufactures Wall and Door Protection for worldwide customers. Our products are an integral part of commercial projects to prevent damage and safeguard your building investment. Recognized as an industry leader, Babcock-Davis has been relied upon by building and construction professions for over 50 years and we pride ourselves in offering exceptional technical support.

Please do not return any product before discussing your application problem with a Babcock-Davis representative and obtaining a Return Authorization.

Your Babcock-Davis representative is eager to help you. Please feel free to call your representative or contact Babcock-Davis to discuss your application.

Babcock-Davis  
9300 73rd Avenue North  
Brooklyn Park, MN 55428

Phone: 888.412.3726  
Fax: 888.312.3726  
Email: [info@BabcockDavis.com](mailto:info@BabcockDavis.com)

Visit [www.BabcockDavis.com](http://www.BabcockDavis.com) for the latest version  
of this document and more information.

Great Products.  
Better Partners.



9300 73RD AVENUE NORTH  
BROOKLYN PARK, MN 55428

(888) 412-3726  
(888) 312-3726 FAX

[WWW.BABCOCKDAVIS.COM](http://WWW.BABCOCKDAVIS.COM)